

30-FOOT AIRSTREAM LINER

Here is the lightest trailer of its size in the world. It's a big, roomy, 4-wheel tandem, yet it can be towed easily by any passenger auto. Nowhere can you buy a trailer with so much livability, yet pull around with so little effort. Everything is big and deluxe in the Airstream Liner... an abundance of space and conveniences to make it outstandingly comfortable and liveable. All the genius of Airstream design, all the experience of extensive travel testing have gone into the building of this great model. Wherever you stay, you will enjoy living in it... wherever you go you will enjoy taking it with you.

\$4945

SPECIFICATIONS

Overall length - 30 ft.
Body length - 27 ft.
Overall height - 8' 4"
Inside height - 6' 4"
Overall width - 7' 1"
Inside width - 6' 10"
Overall weight - 4050 lbs.
Hitch weight - 320 lbs.

STANDARD EQUIPMENT

Double or twin beds, airfoam mattresses and box springs
Sofa in front, convertible single, double bed
Hot water heater
Shower and toilet Separated over and Burner Top arrangement discontinued.
Oil or butane heat
Built-in de luxe oven and broiler with separate 4-burner stove top
Double sinks
Combination electric-ice refrigerator
Formica galley top
Beautifully grained wood cabinets
Vinyl linoleum
5 closets, 16 drawers, 5 roof lockers
Medicine cabinet
11 large windows, 3 roof vents
Curtains and draw shades
8" power fan over stove
Double butane tanks
Weatherproof electric outlet
20-ft. awning rail
Porch light
Trunk compartment
Steel bumpers
Shock absorbers
Electric brakes
Tandem truck wheels
700-15 6-ply tires
Escape-type rear window

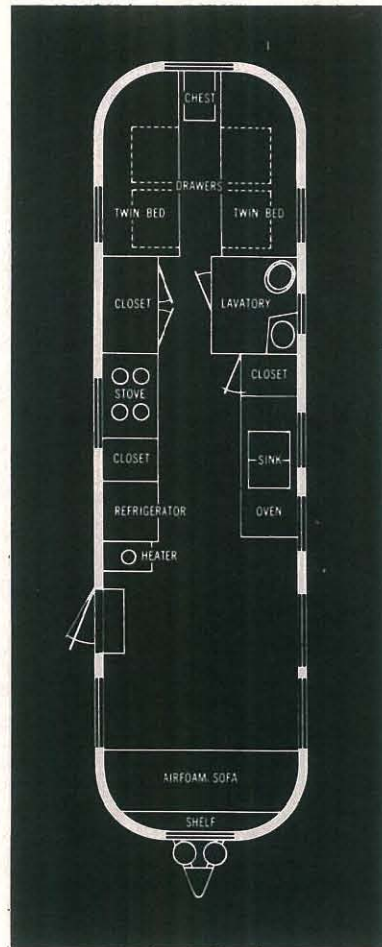

Airstream - since 1932 the world's finest lightweight travel trailers



Standard Door Hinging Main Doors Are Hinged
On Forward Edge -- Standard Installation

54

Prices and specifications subject to change without notice.