

# 18 FT. *Comet* by AIRSTREAM

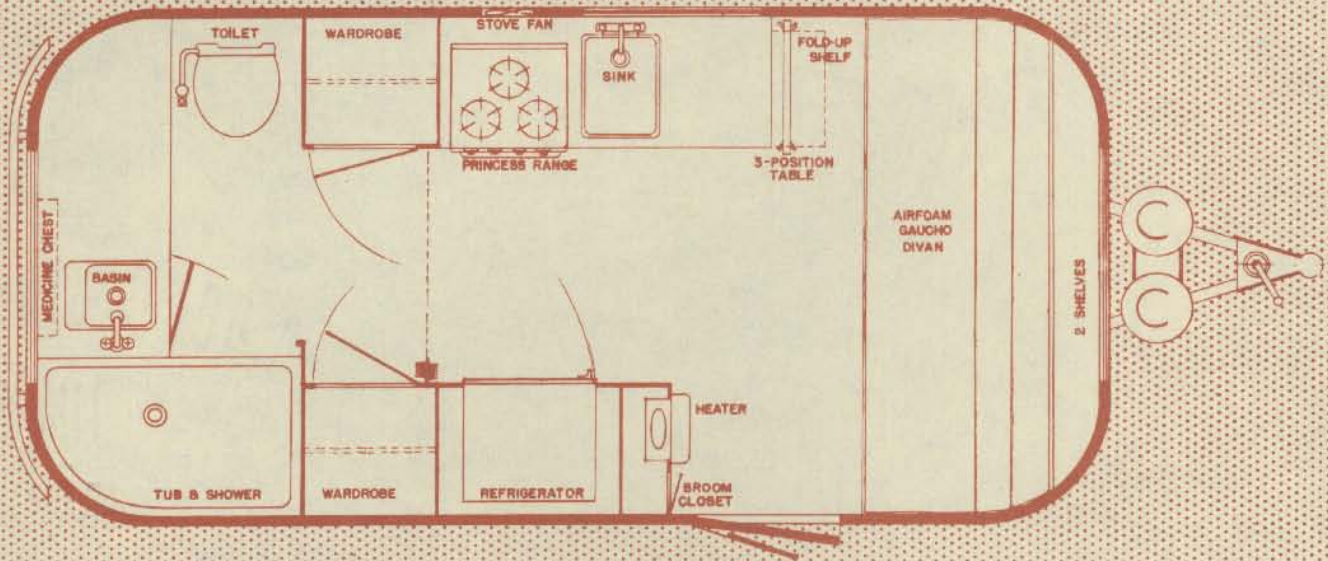

## BEAUTIFUL, COLOR-COORDINATED INTERIORS

ALWAYS THESE FAMOUS AIRSTREAM FEATURES...

- all-metal, all-aluminum airplane type construction
- all-steel undercarriage for maximum strength in motion
- all-riveted unitized body, both interior and exterior
- all-over special aircraft-type fiberglass insulation
- vibration-proof fastenings to withstand stresses

## SPECIFICATIONS AND STANDARD EQUIPMENT\*

Overall length- 18 ft	Inlaid linoleum	3 position table
Body length- 15 ft	Butane water heater	Large wash basin
8 ply tires	Gear operated windows	Medicine chest
Heavy duty axle	Escape windows	Vented butane heater
Hydraulic or electric brakes	Twin butane tanks	85" x 48" airfoam bed
2" fiberglass insulation	Full screen door	Butane refrigerator
Steel bumper	Stainless steel door hinges	2 full-length wardrobes
Flush toilet	8' awning rail	Private dressing-room bathroom
Oven & broiler stove	Roof vent	Ample storage drawers
Stove fan	Touch control built-in step	60" full depth roof locker
Warp-free hollow core doors	Fiberglass bathtub with shower	"Sanitator" unit
Formica galley top		

\*Subject to change without notice

PRICE \$ 3,695.00 F.O.B. SANTA FE SPRINGS, CALIFORNIA

**SINCE 1932 THE WORLD'S FINEST LIGHTWEIGHT TRAVEL TRAILERS**

AIRSTREAM INC • 12804 E. FIRESTONE BLVD, SANTA FE SPRINGS, CALIF • SANTA ANA FREEWAY AT ROSECRANS