

**SENSATIONAL  
NEW AIRSTREAM  
TRAVEL TRAILER**

# 18 FT. TRAVELER



## THE NEW LIGHTWEIGHT GO-ANYWHERE TRAILER

Here's a remarkable new model designed to meet the need for a compact, sturdy, go-anywhere trailer. Light on the hitch, light on the hills and comfortable inside, the Traveler is the perfect small home on wheels. You'll be amazed by how much convenience and livability has been incorporated in this small trailer. Just look at all these great features: a convenient front end with airfoam dinettes; combination ice-electric refrigerator; good-sized oven and stove, convenient formica galley top; flush toilet; large closet and storage area; wonderfully comfortable airfoam double bed—and many other exclusive Airstream features. We think that the Traveler is the world's finest small travel trailer—a "natural" for those who want a lightweight trailer to go places at a price you can afford. And remember, every Airstream is guaranteed for life... the good life... the life you should be leading now.



*Airstream—since 1932 the world's  
finest lightweight travel trailers*



**AIRSTREAM**  
TRAILERS, INC.

12804 E. FIRESTONE BLVD, SANTE FE SPRINGS, CALIF • SANTA ANA FREEWAY AT ROSECRANS



# BEAUTIFUL, COLOR-COORDINATED INTERIORS

ALWAYS THESE FAMOUS AIRSTREAM FEATURES...

- all-metal, all-aluminum airplane type construction
- all-riveted unitized body, both interior and exterior
- all-steel undercarriage for maximum strength in motion
- all-over special aircraft-type fiberglass insulation
- vibration-proof fastenings to withstand stresses

## SPECIFICATIONS AND STANDARD EQUIPMENT \*

Overall Length—18 ft.	Comb. ice-electric refrig.
Body length—15 ft.	Oven stove
Overall weight—2100 lbs.	Inlaid linoleum
Hitch weight—220 lbs.	Gear-operated windows
6 ply tires	Butane tank
Heavy-duty axle	Full screen door
Brakes	Formica galley top
Steel bumper	Double closet
2" fiberglass insulation	Touch control built-in step
Airfoam dinettes	Warp-free hollow core doors
Airfoam double bed	Trunk door
Flush toilet	Awning rail
Escape window	Wall-mounted stove fan
Medicine chest	*Subject to change without notice

*"Interior colors by Drawbolt of Beverly Hills"*

## 18 FT. MODEL

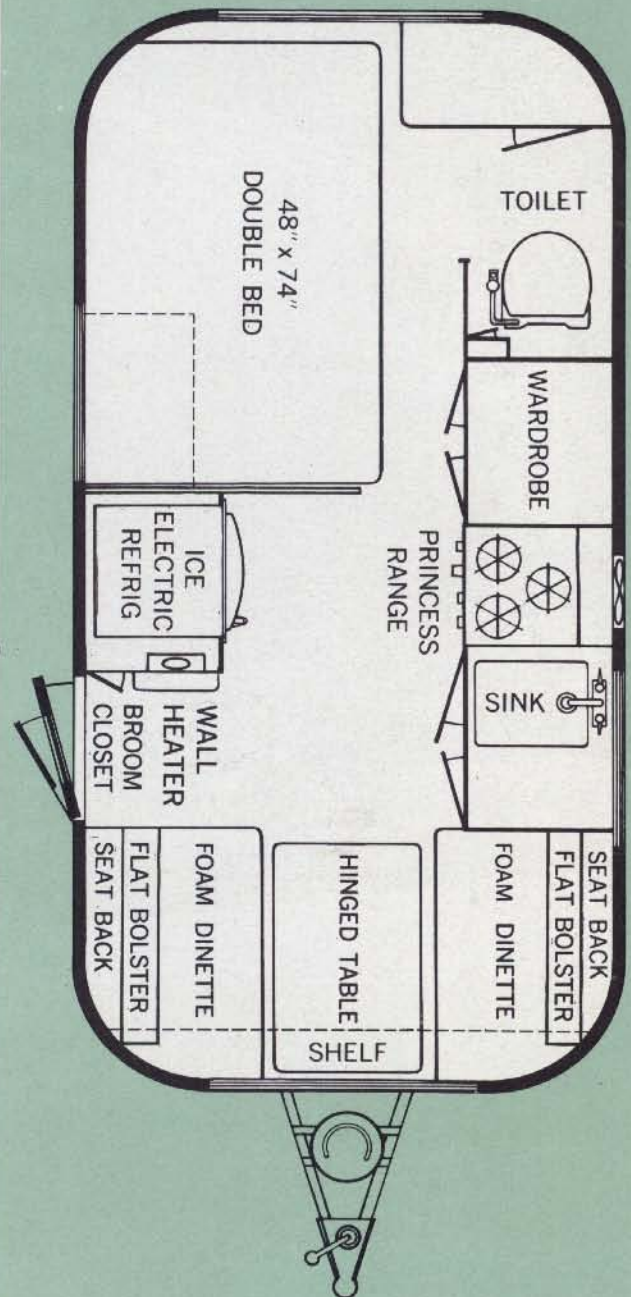

## THE NEW LIGHTWEIGHT GO-ANYWHERE TRAILER

**SINCE 1932 THE WORLD'S FINEST LIGHTWEIGHT TRAVEL TRAILERS**

AIRSTREAM TRAILERS INC • 12804 E. FIRESTONE BLVD. SANTE FE SPRINGS, CALIF • SANTA ANA FREEWAY AT ROSECRANS