

1931

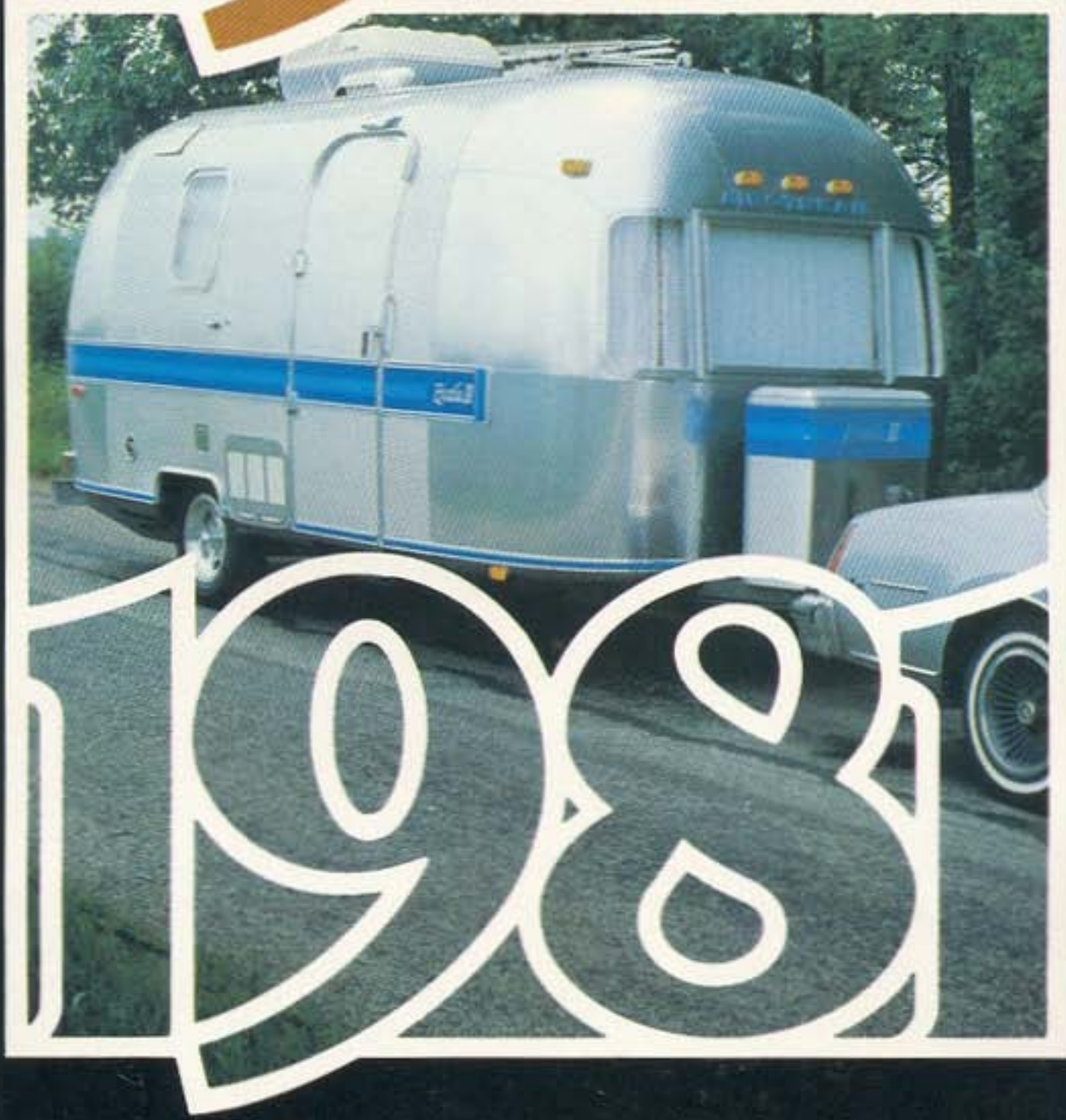

The 100,000th Airstream trailer built since 1931.

AIRSTREAM VS. THE INCREDIBLE HULKS

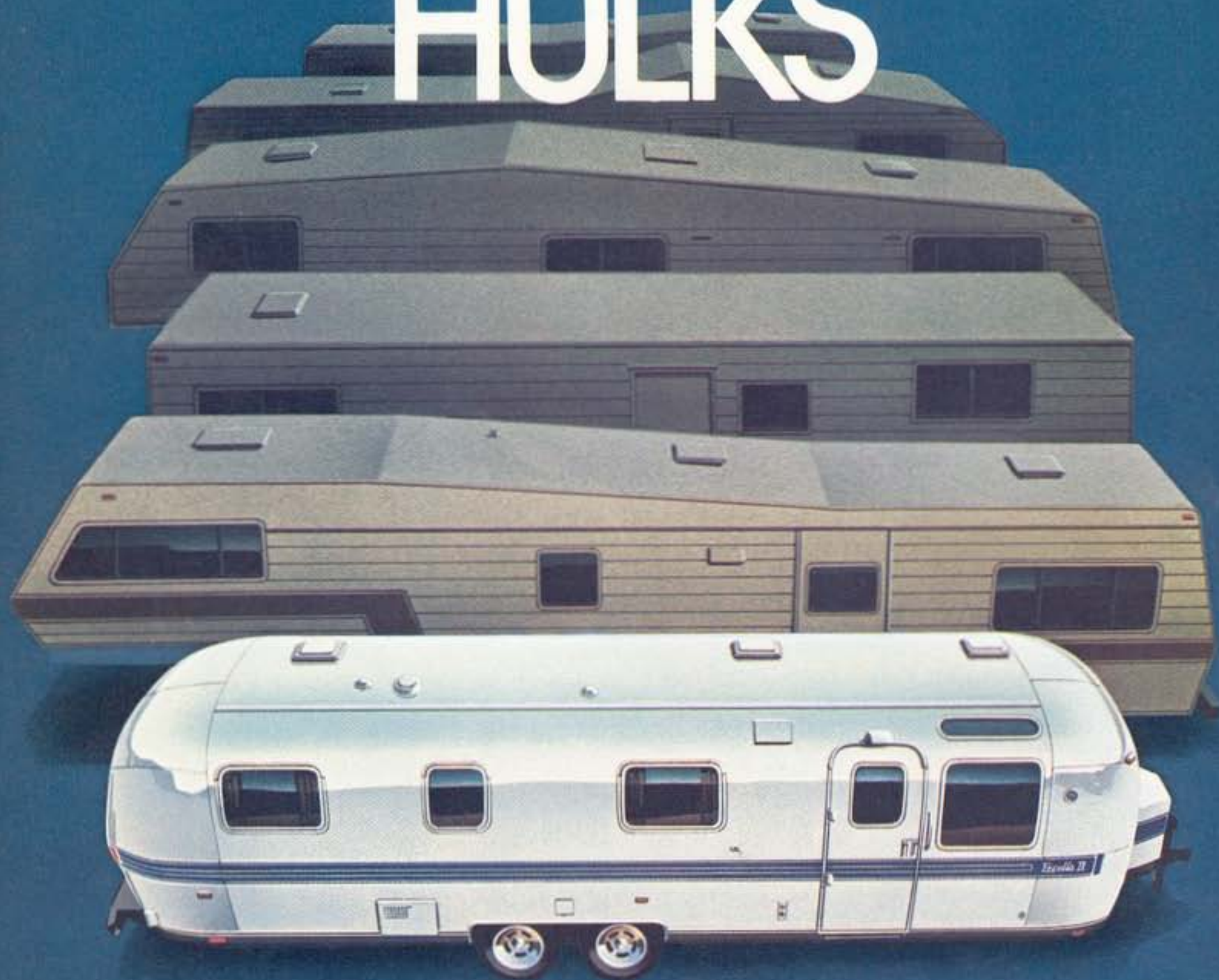

WITH AN AIRSTREAM ALL THE LUXURY

Airstream comes through in the crunch.

With the price of fuel going up, and the supply going down—you've probably been thinking about going nowhere. And that would be a shame.

Because if you love trailering—if it's part of your lifestyle—you shouldn't have to think about giving it up. You should think about conserving.

Economizing.

And Airstreaming.

With an Airstream, you can travel well, travel light, and still luxury. Box-type trailers just can't compete. They're overweight. They put too much strain on your tow vehicle. They drain your gas tank. And, they might eat you out of house and home.

A lightweight, aerodynamic, energy-efficient Airstream will see you through hard times. And give you better times in better times.

Sensibly priced, and sized in new lengths for every type of family—a 1980 Airstream is the very best Airstream of all.

Airstream carries every comfort. Not dead weight.

For years, we've been designing Airstreams with the best of everything.

Kitchens fit for accomplished cooks. Full-sized baths. Dining/living areas with fine, sleek furnishings. Airstream is built with every comfort. And one thing more. Practicality.

Instead of constructing our interiors with heavy, conventional materials—cabinets, storage and furnishings are custom-designed to be lightweight, functional, and beautifully "Airstreamed."

And, instead of designing trailers for standing still—we engineer our trailers to perform perfectly all the time. Even when traveling.

Airstream gives you the most that weighs the least. In the past, it always made a lot of sense. Today, it wouldn't make sense to do it any other way.

Aerodynamic design is beauty.

Why does an Airstream travel like a stream of air? And, unlike box-type trailers—how does an Airstream overcome wind drag, regardless of weather conditions?

The answer is simple. A lightweight, aerodynamic design coupled with an aircraft-type construction.

Our famous silver exterior is actually aluminum sheeting riveted securely over a strong aluminum cage. So sturdy yet so lightweight. And, our smooth rounded shape (established on aerodynamic principles) is what keeps our travel trailer traveling so well. Helping to save you costly fuel bills.

The Airstreams of the 80's have even more to offer.

A reliable, maintenance-free "Dura-Torque" suspension system for smoother rides and increased lateral stability. Exclusive "Excella-Vac" disc brakes to bring your car and trailer to a simultaneous halt. A low center of gravity and an extra-wide wheel stance for improved handling in crosswinds, around curves—even around hairpin turns.

Constantly improving, Airstream meets today's problems head on. That's why we'll still be on the road tomorrow.

We've gone to great lengths so that everyone can own an Airstream.

The Airstreams of the 80's. They're for young married couples



20' Caravelle



25' International



28' International



31' Excella II

M, YOU CAN AFFORD RIES. EVEN GAS.



who want to get going. For retired folks who want to keep going. For growing families of three, four or more. And for those who could never afford one before!

With new compact 20-, 22- and 24-foot lengths—at new streamlined prices—Airstream is the future of leisure living for economy-minded travelers.

Our brand new mini *Caravelle* models are the lightest of all to tow. They're perfect for today's smaller cars, and for families on smaller budgets. Built to save you dollars at the gas pump—these new top-flight RV's have been designed with 46 years of knowledge and craftsmanship. They sleep from four to seven. You can load them up with options or ride along beautifully with fine, standard equipment. They may be low in cost, but the quality has never been higher. If you've had your eye

on our top-of-the-line, this year might be your year to buy. The 1980 *Excella II* has rich new interiors with light, wood-like Sunbeech paneling... decorator fabrics in delicate earth tones... elegant parquet flooring**... and more. Everything's been

upgraded—except the price! Available in 25-, 28- and 31-foot lengths, the *Excella* excels in every way. Now's your chance to trade up, and wind up with a great deal.

When you decide on a 1980 medium-priced *International* you'll be touring in a 25-, 28- or 31-foot luxury

machine—built with common sense and fashion sense. You'll have room to sleep four, and the option to sleep seven. As well as easy-to-care-for furnishings, a choice of floorplans, and ample storage.

All these luxury trailers are more than good buys. More than good investments. They're 1980 Airstreams. And you can't hitch up with any better than that.

Airstream. The Trailer with a high resale value and a long, happy life.

On January 15th, 480 Airstreamers left for a two-month tour of Mexico.

Every family towed an Airstream. There were '79 models, '69 models—even one from '51. All 251 trailers put on a heap of trouble-free miles. And everyone shared good times.

For thousands of folks, Airstreaming is a wonderful way of life. Here's why: With every Airstream you buy, you get years of happy traveling—in a handcrafted machine.

You get a nationwide network of certified service centers.

You become part of one of the most exciting travel groups in the world. A "club" that has opened doors for Airstreamers in more than 120 countries.

And best of all, you get an exceptional deal when it's time to trade in your old Airstream for a newer model. (Some owners have resold their Airstreams for more than the original purchase price!)

When you buy an Airstream, you're buying a leader. And this year—especially—Airstream is the leader in value, too.



*Available in 28' & 31' models only.
**Optional

EXCELLA II FLOOR PLANS

31' Center Bath Twin Model

Features a spacious rear bedroom with fixed twin beds and night stand.
Hitch Wt.: 606 lbs.
Trailer Wt.: 4,795 lbs.

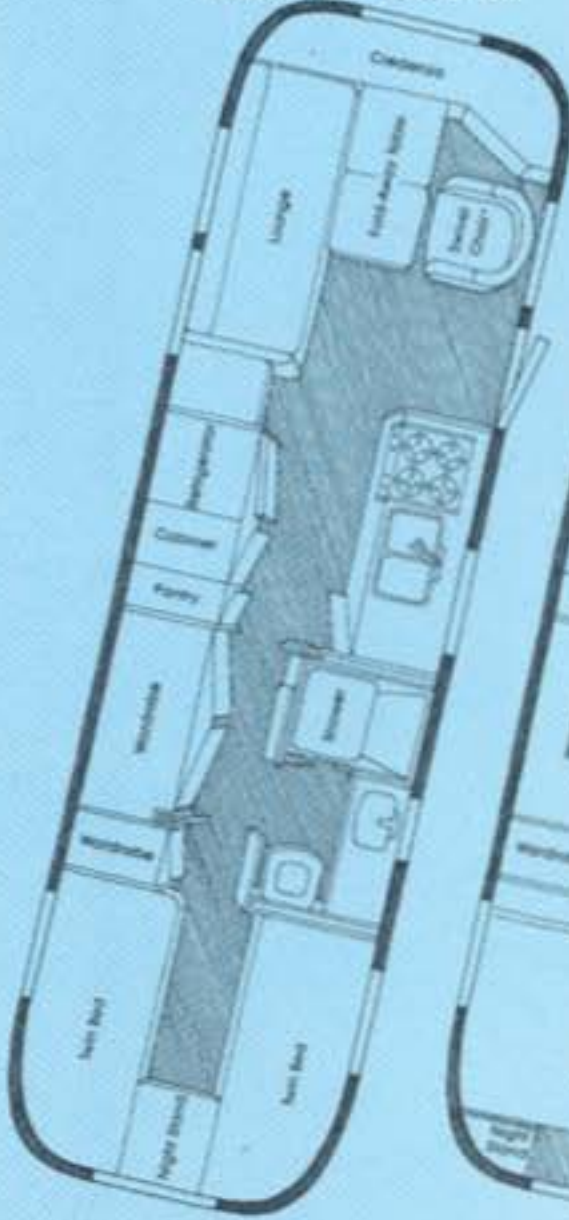

31' Center Bath Double Model

Features a spacious rear bedroom with fixed double bed and night stand.
Hitch Wt.: 606 lbs.
Trailer Wt.: 4,785 lbs.

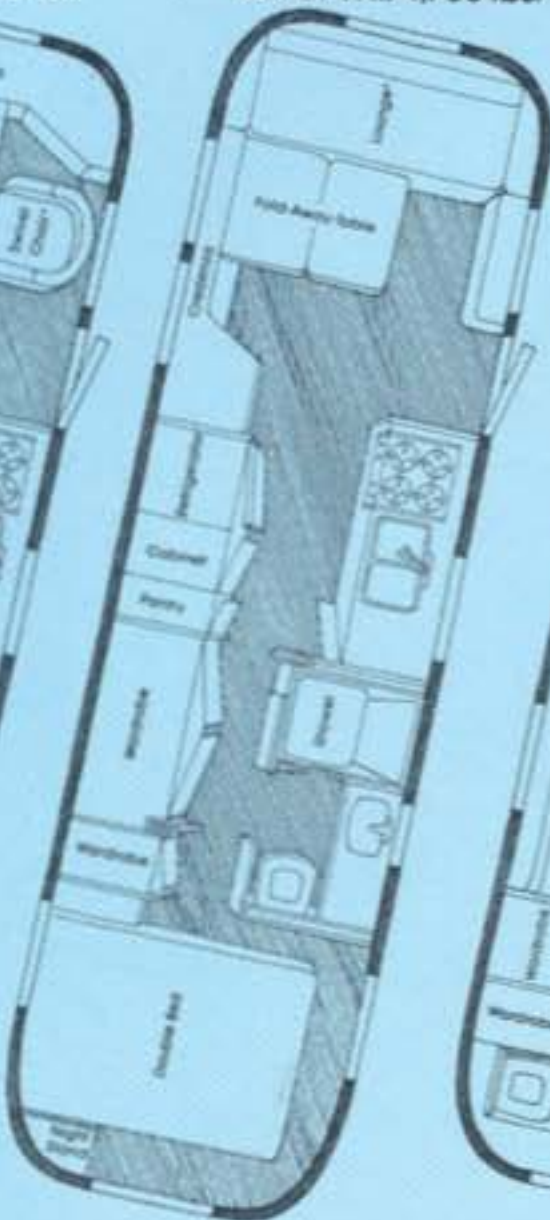

31' Rear Bath Double Model

Features a center bedroom with pull-out lounge and vanity. Front pull-out lounge is optional.
Hitch Wt.: 650 lbs.
Trailer Wt.: 4,762 lbs.

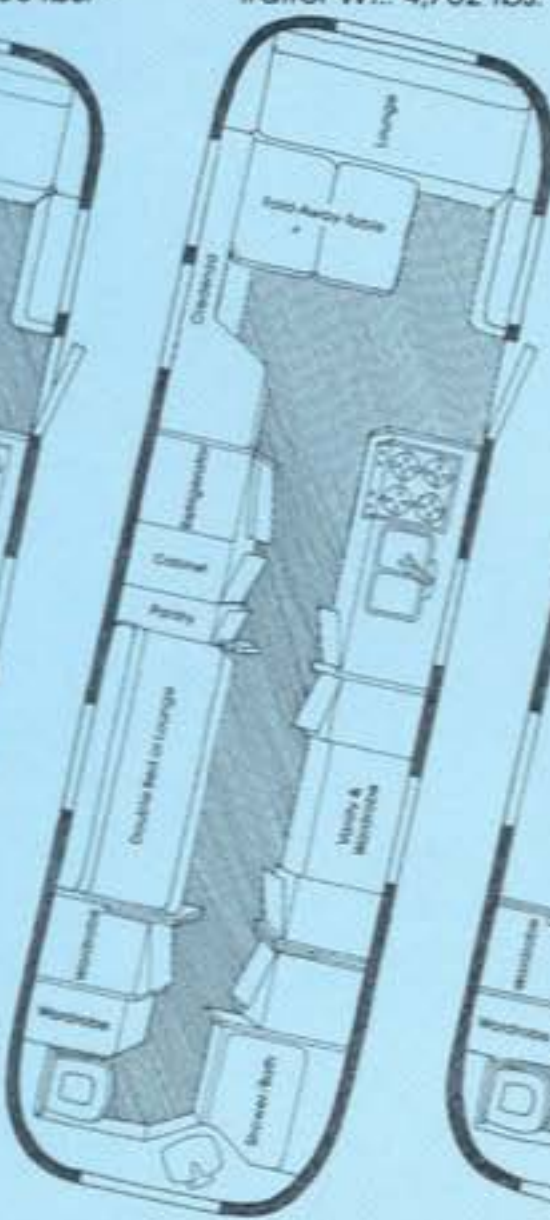

31' Rear Bath Twin Model

Features a center bedroom area with fixed twin beds. Front pull-out lounge is optional.
Hitch Wt.: 622 lbs.
Trailer Wt.: 4,691 lbs.

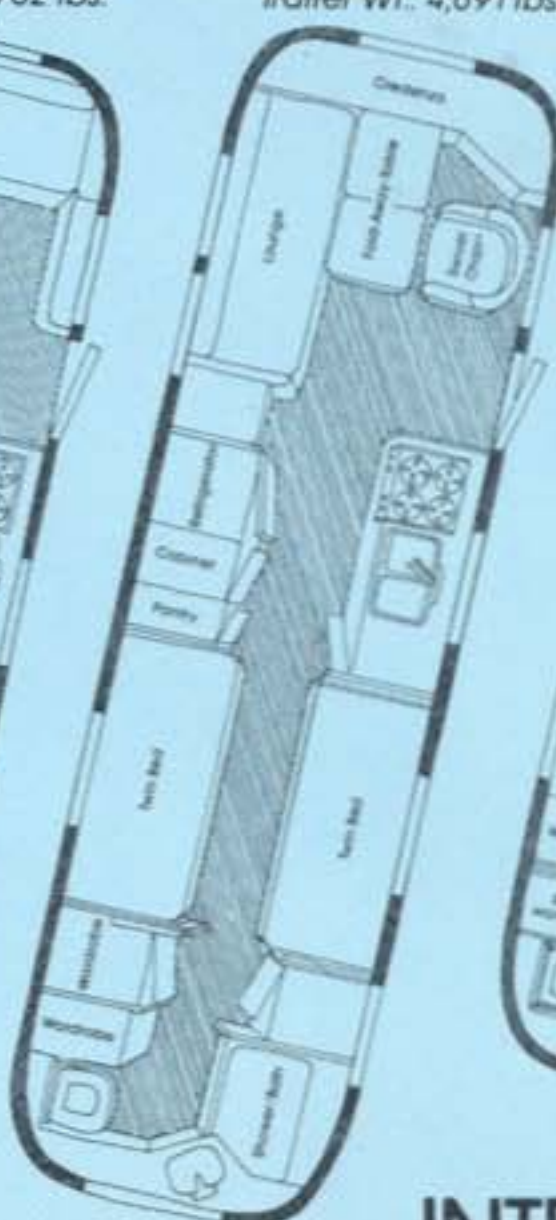

28' Double Model

Features a full, rear bath and center sleeping area with either a fixed double bed or pull-out lounge plus vanity.
Hitch Wt.: 650 lbs.
Trailer Wt.: 4,504 lbs.

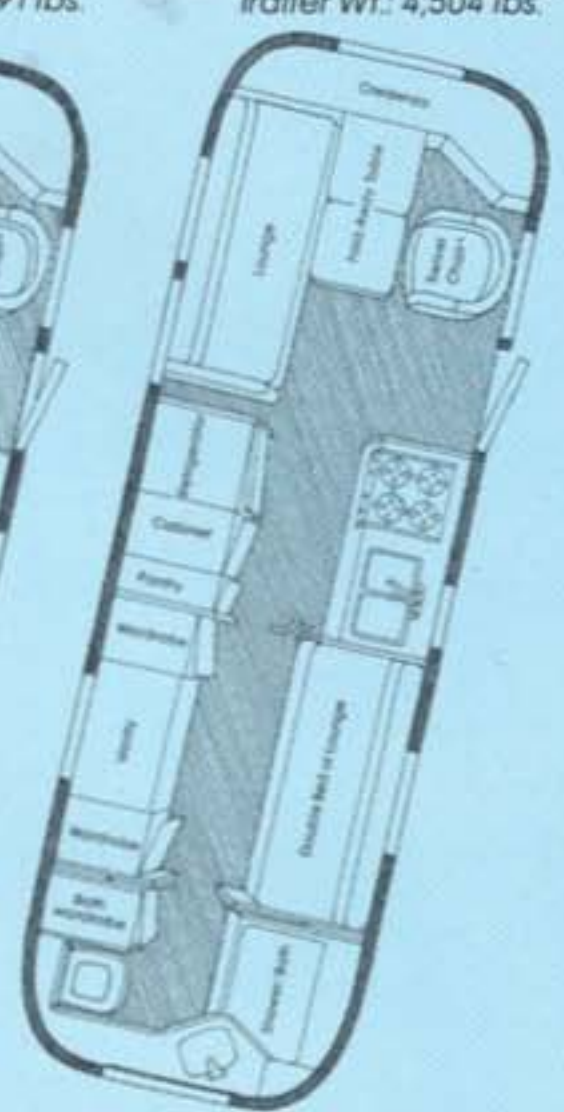

INTERNATIONAL FLOOR PLANS

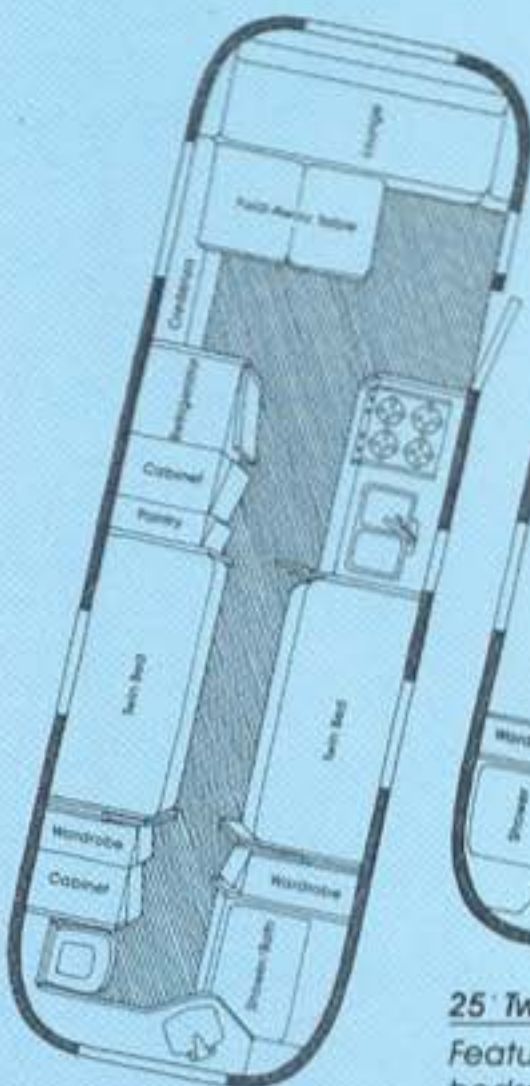

28' Twin Model

Features a full, rear bath and twin-bedded sleeping area. Front lounge option shown.
Hitch Wt.: 622 lbs.
Trailer Wt.: 4,443 lbs.



25' Twin Model

Features a center bedroom area with fixed twin beds and two wardrobes.
Hitch Wt.: 669 lbs.
Trailer Wt.: 4,244 lbs.

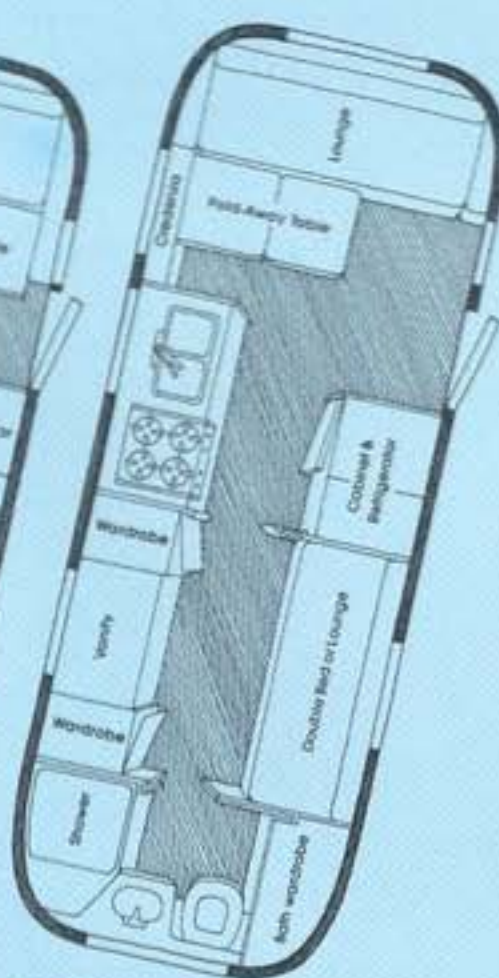

25' Double Model

Features a front pull-out lounge and center bedroom area with side pull-out lounge and dressing vanity.
Hitch Wt.: 604 lbs.
Trailer Wt.: 4,212 lbs.

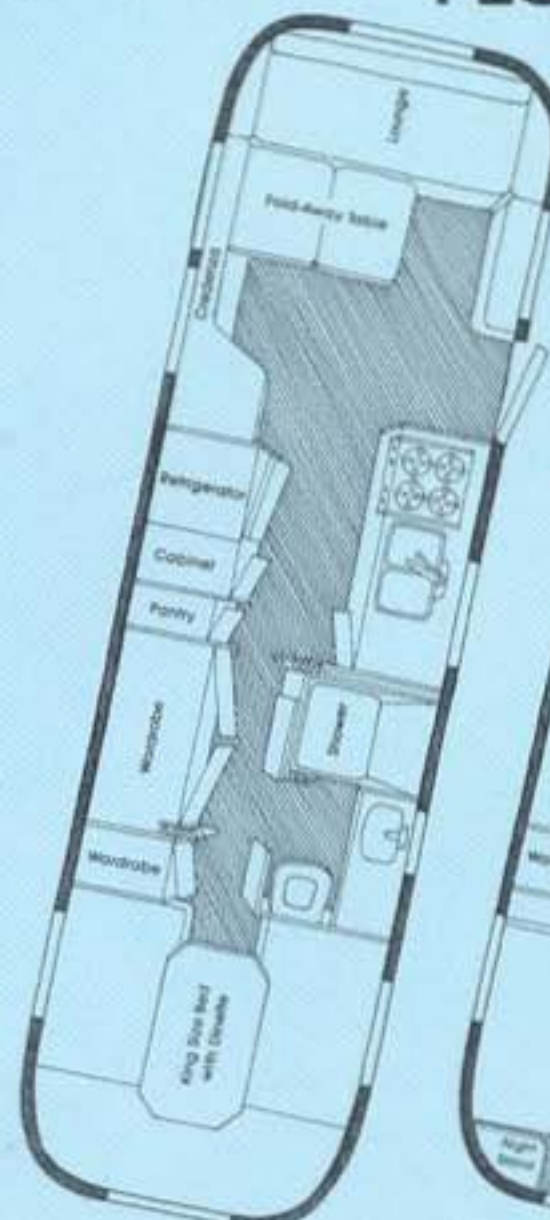

31' Center Bath w/Rear Dinette Model

Features a king-size bed/dinette option in the rear and an optional front lounge arrangement.
Hitch Wt.: 583 lbs.
Trailer Wt.: 4,603 lbs.

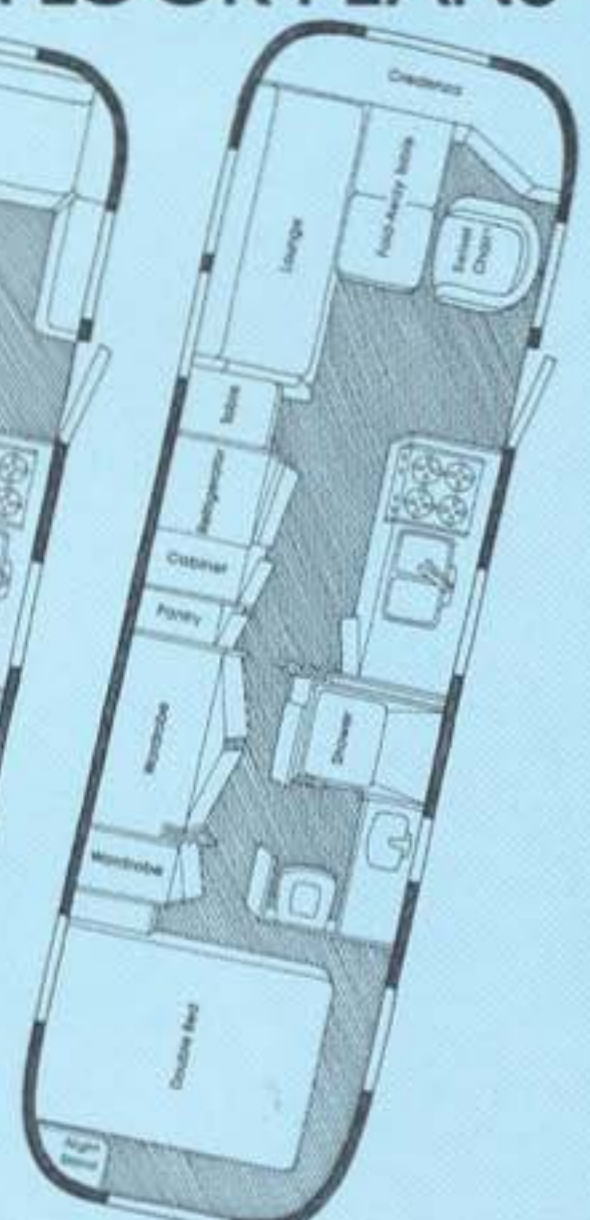

31' Center Bath Double Model

Features a large rear bedroom with fixed double bed and night stand.
Hitch Wt.: 583 lbs.
Trailer Wt.: 4,603 lbs.

Note: All hitch weights and trailer weights quoted are for standard equipped models, ready for delivery. Not included is the weight of water, butane or personal belongings carried in the trailer.

*Optional

INTERNATIONAL FLOOR PLANS (continued).

31' Center Bath Twin Model

Features a spacious rear bedroom area with fixed twin beds and night stand. Hitch Wt.: 583 lbs. Trailer Wt.: 4,612 lbs.

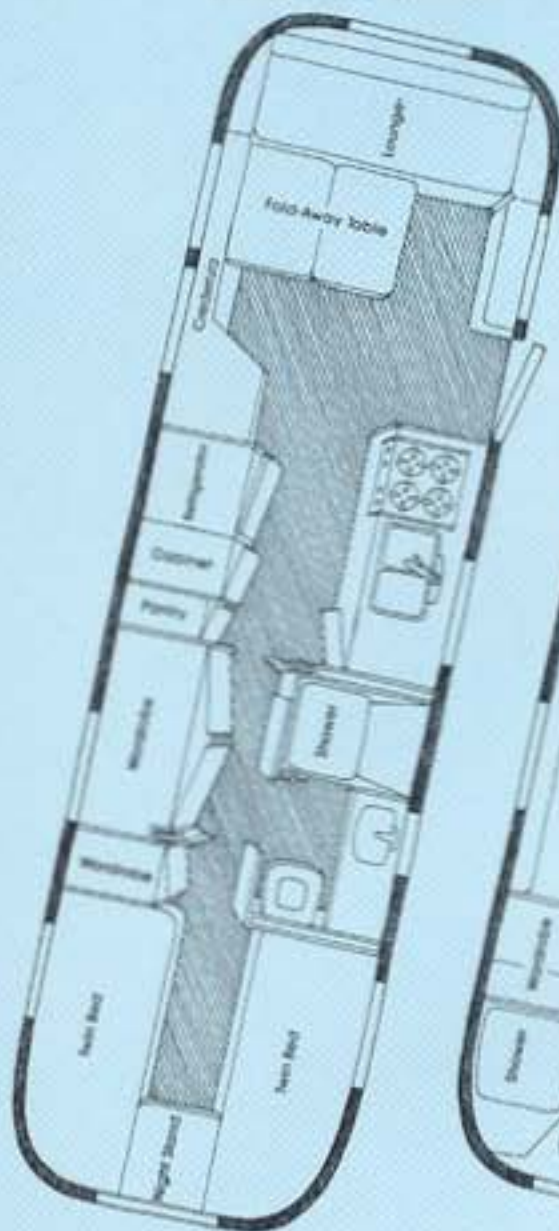

31' Rear Bath Twin Model

Features a cozy center bedroom area - shown with twin/double bed/bunk option. The convertible front dinette area is optional. Hitch Wt.: 571 lbs. Trailer Wt.: 4,485 lbs.

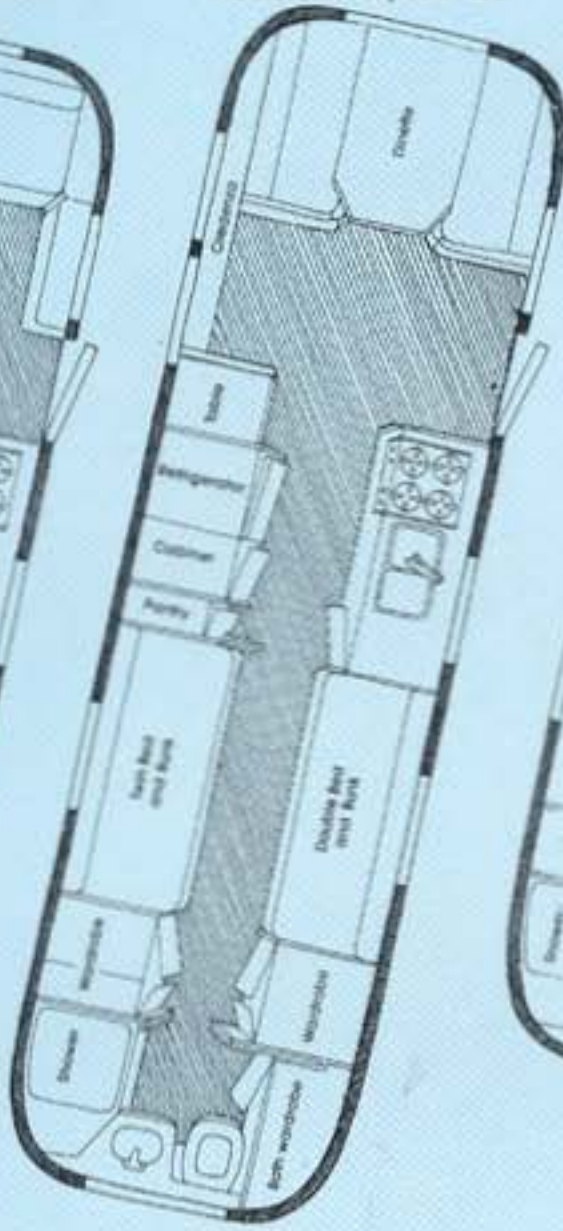

28' Twin Model

Features a side lounge in living area. Front lounge option available. (See 28' double.) Hitch Wt.: 571 lbs. Trailer Wt.: 4,143 lbs.

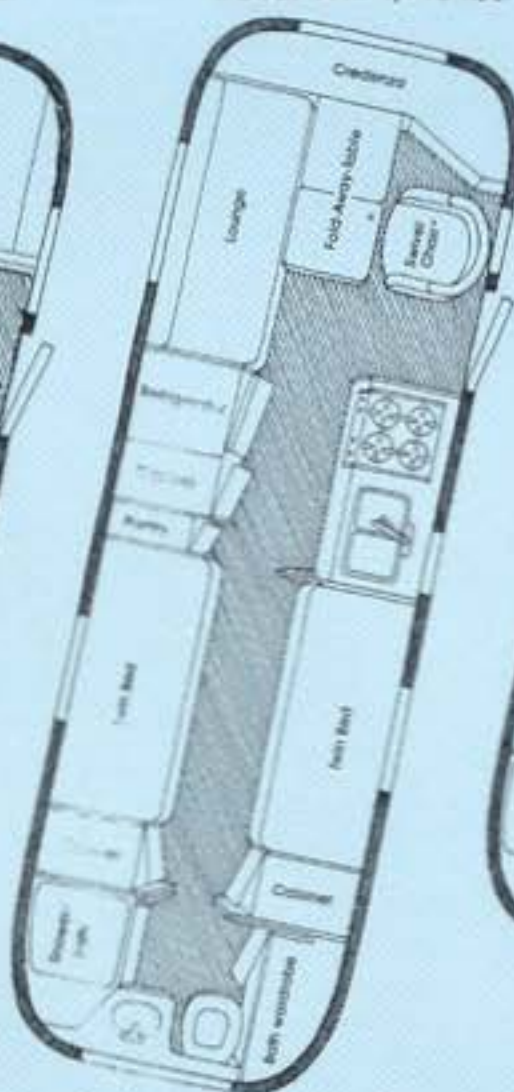

25' Twin Model

Features a front pull-out lounge, rear bath, and private bedroom area with fixed twin beds. Hitch Wt.: 614 lbs. Trailer Wt.: 3,956 lbs.

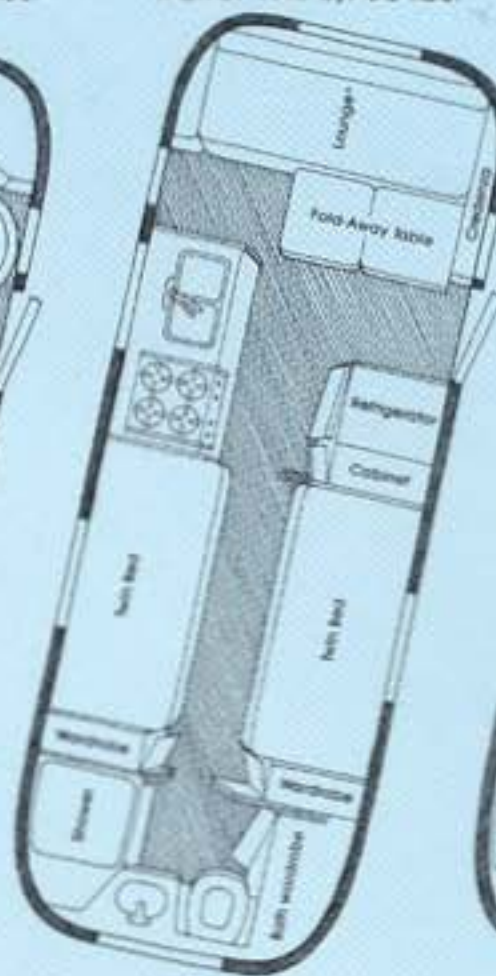

25' Double Model

Features a front pull-out lounge and private bedroom area with a fixed double bed or pull-out lounge plus vanity. Hitch Wt.: 554 lbs. Trailer Wt.: 3,926 lbs.

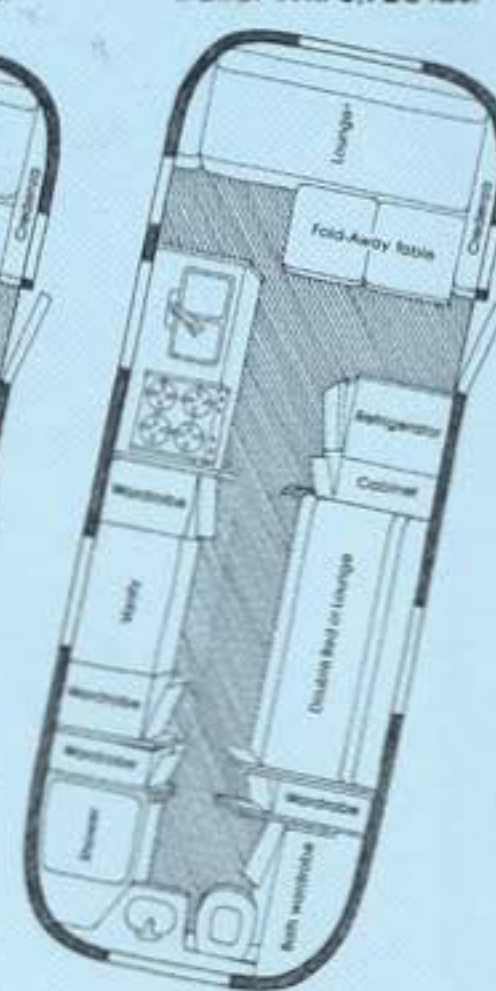

CARAVELLE FLOOR PLANS

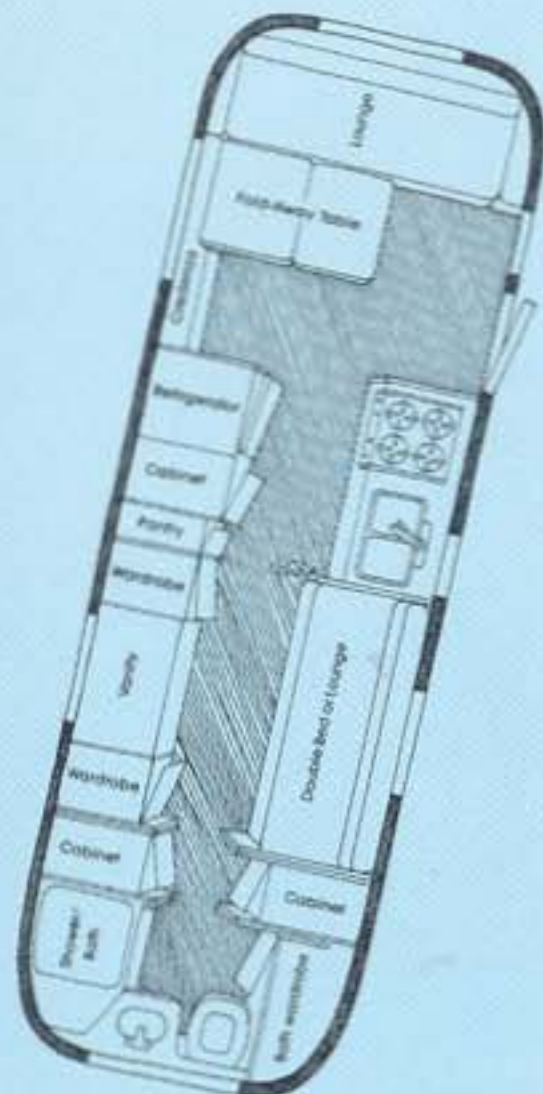

28' Double Model
Features a private bedroom area with fixed double bed or pull-out lounge plus vanity. Front pull-out lounge is optional. Hitch Wt.: 597 lbs. Trailer Wt.: 4,200 lbs.

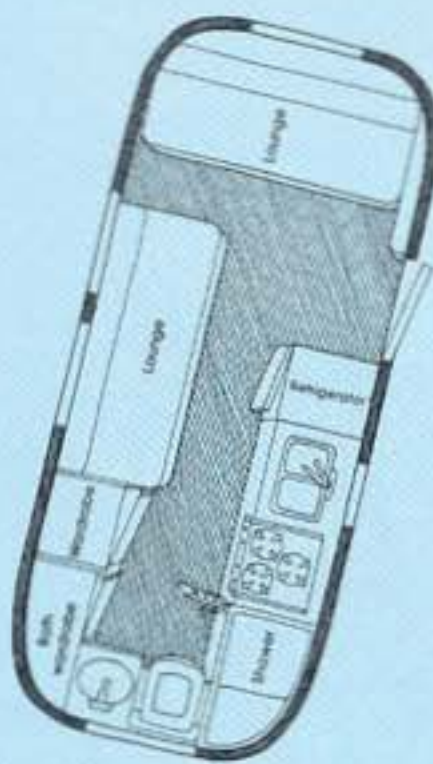

20' Double Model
Features a side pull-out lounge. Front pull-out lounge is optional. Dinette arrangement, pictured in 22' model, is standard. Hitch Wt.: 309 lbs. Trailer Wt.: 2,539 lbs.

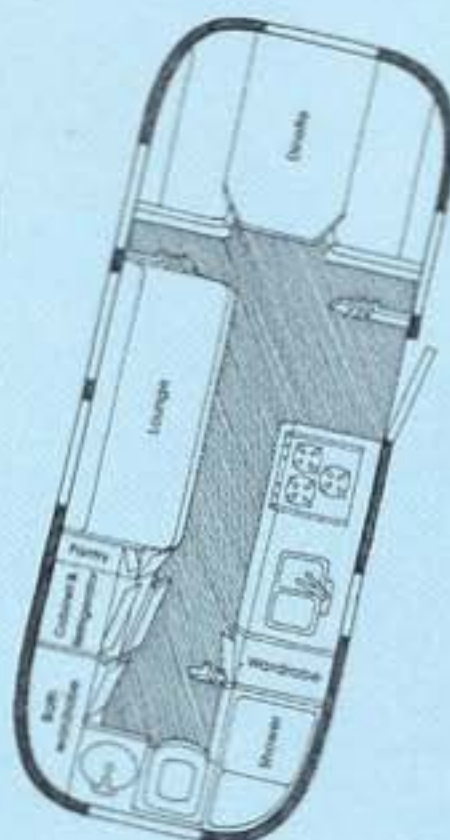

22' Double Model
Features a dinette area which converts to a double-bedded sleeping alcove when dining table is lowered. Also available with front lounge arrangement pictured in the 20' model. Hitch Wt.: 249 lbs. Trailer Wt.: 2,799 lbs.

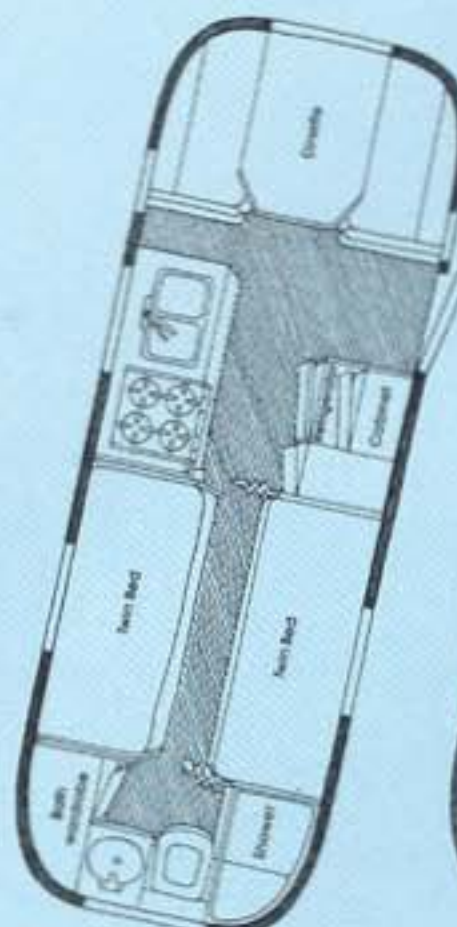

24' Twin Model
Features a separate bedroom area with fixed twin beds. Bolster bunks are optional. Dinette is standard. Front lounge, pictured in 20' model, is optional. Hitch Wt.: 347 lbs. Trailer Wt.: 3,317 lbs.

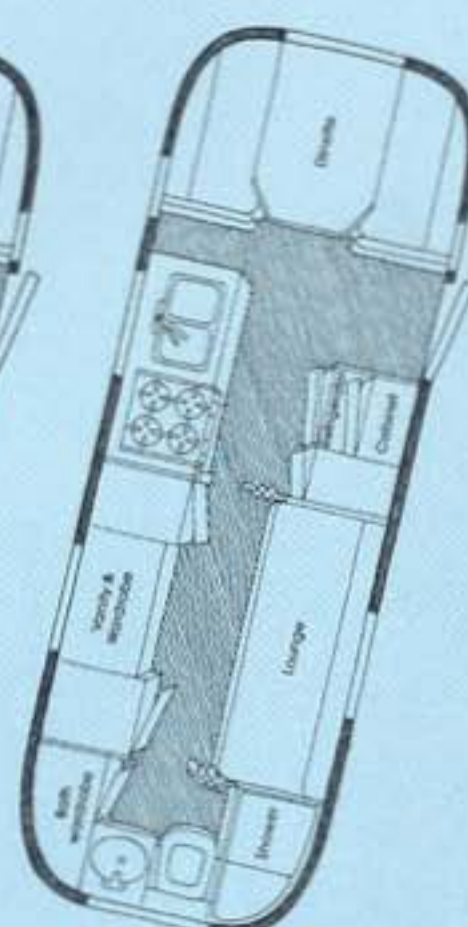

24' Double Model
Features a separate bedroom area with a side pull-out lounge and vanity. Dinette arrangement is standard. Front lounge, pictured in 20' model, is optional. Hitch Wt.: 347 lbs. Trailer Wt.: 3,317 lbs.

31' Rear Bath Double Model (not shown)
Hitch Wt.: 597 lbs. Trailer Wt.: 4,552 lbs.

Note: All hitch weights and trailer weights quoted are for standard equipped models, ready for delivery. Not included is the weight of water, butane or personal belongings carried in the trailer.
* Optional

GENERAL SPECIFICATIONS

Dimensions

- Outside floor width . . . 7'8"
- Outside height from ground . . . 8'10"
- Inside height (floor to ceiling) . . . 6'7"
- Ground clearance . . . 16" to underbelly, 12.24" to axle tube
- Recommended hitch ball height . . . 19 1/2"

Construction Features

- Aerodynamic design with continuous curved aluminum shell, contoured window glass, frames and doors
- Hand-riveted semi-monocoque shell of heat-treated structural alloy aluminum
- Ribs of stretch-formed structural alloy aluminum
- Interior walls of wear-resistant, vinyl-covered aluminum
- Exterior automotive-type acrylic coating (silver models)
- 2 1/4 inch fiber glass insulation
- Double-walled fiber glass insulated wheel wells
- Exclusive high-strength steel undercarriage
- Extruded aluminum bumper
- Aluminum folding step (steel on Caravelle)
- LPG tank cover (Excella II)
- Awning rail
- Dura-Torque axles
- Shock absorbers on all wheels
- Electric drum brakes: 12" on 28' & 31' models, 10" 20', 22', 24' and 25' models
- Bias belted BW tires (load range C) on automotive-style steel wheels with wheel covers (hub caps on International and Caravelle)
- Automatic breakaway control
- Security door lock (Excella II)

Storage

- Lightweight, warp-free, honeycomb core doors
- Positive latches on all cabinet doors
- Bed drawers of lightweight high-impact plastic
- Lightweight injection molded galley and vanity drawers
- Silverware drawer
- Built-in medicine cabinet and mirror
- Panoramic roof lockers with mirror doors in full bath models
- Clothes hamper and bag (full bath models)
- Galley storage
- Roof lockers
- Spice rack (Excella II)

Windows and Vents

- Picture window in lounge (N/A in 20' model)
- One-piece stretch-formed, extruded aluminum window frames
- Exclusive contoured single-paned safety-glass windows
- Super strength front window (safety glass)
- Corrosion-proof screens in all windows
- Bug seal (Excella II)
- Adjustable aluminum roof vents

Plumbing and Fixtures

- Thermo-formed bathroom with tub (28' and 31' Excella II)
- Molded shower (Caravelle, International and 25' Excella II)
- High-volume water pressure regulator in water inlet line
- Lockable, fresh water fill
- Single control bath and galley faucets (dual control in International and Caravelle)
- Toilet water saver (Excella II)

- Univolt demand pump (capacity 3 gallons per minute)
- Drainage drop-out cover cap
- Drainage drop-out elbow for connecting sewer hose
- Built-in sewer hose carrier
- Mechanical seal, flush toilet
- Swing faucet at double galley sinks
- Water-saver "telephone" shower head
- A.N.S.I., D.O.H. (C.S.A. Optional) Recreation Vehicle Code-approved plumbing system
- Stainless steel galley sinks
- 50-gallon drainable water tank (25 gallon on Caravelle)

Electrical and Lighting Equipment

- A.N.S.I., D.O.H. (C.S.A. Optional) Recreation Vehicle Code-approved electrical system
- N.E.C. Code-approved wiring system
- Detachable single-plug weather-proofed car/trailer connector (includes 12-volt charge line)
- Back-up lights
- Built-in 120-volt service line
- 12-volt batteries in built-in, sealed and vented battery compartment (Excella II 105 amp; International and Caravelle, 72 amp)
- 120-volt exterior patio outlet (Excella II)
- Exclusive one-knob variable position ceiling vents
- Exclusive ferro-resonant Univolt to convert 120-volt city power to 12-volt direct current power and automatically charge battery
- Overload safety fuse coded panel in Univolt wiring system
- Circuit breakers on 120-volt wiring system
- Univolt convenience light in rear service area and side trunk area
- Univolt blower for heat circulating ducts
- Front and rear exterior cluster lights
- Galley lights

Gas Equipment

- A.N.S.I., D.O.H. (C.S.A. Optional) Recreation Vehicle Code-approved gas system
- Gas equipment U.L. or A.G.A. and C.S.A.-approved for use in travel trailers
- Gas space heater with pilot; sealed, thermostat-controlled, outside vented, forced air
- Gas/Electric combination refrigerator (Excella II, 10 c.f.; International plus 24' and 22' Caravelle, 6 c.f.; 20' Caravelle, 4 c.f.)
- High recovery gas water heater with built-in igniter
- 4-burner gas range with oven and broiler (3-burner in Caravelle)
- 7-gallon steel L.P.G. bottles (5-gallon on Caravelle) with manual two-stage regulators

Decor

- Vinyl shower curtain
- Decorator lavatory tops (marble in Excella II, cream in International and Caravelle)
- Woodgrain-patterned wall panels
- Magazine rack and galley flip-up shelf (Excella II and International)
- Bathroom shades
- Bi-fold range cover (Excella II)
- Decorative exterior striping in choices of red, blue or brown (International); rust, blue or green (Caravelle); blue (Excella II)

1980 AIRSTREAM 22'-TANDEM AXLE

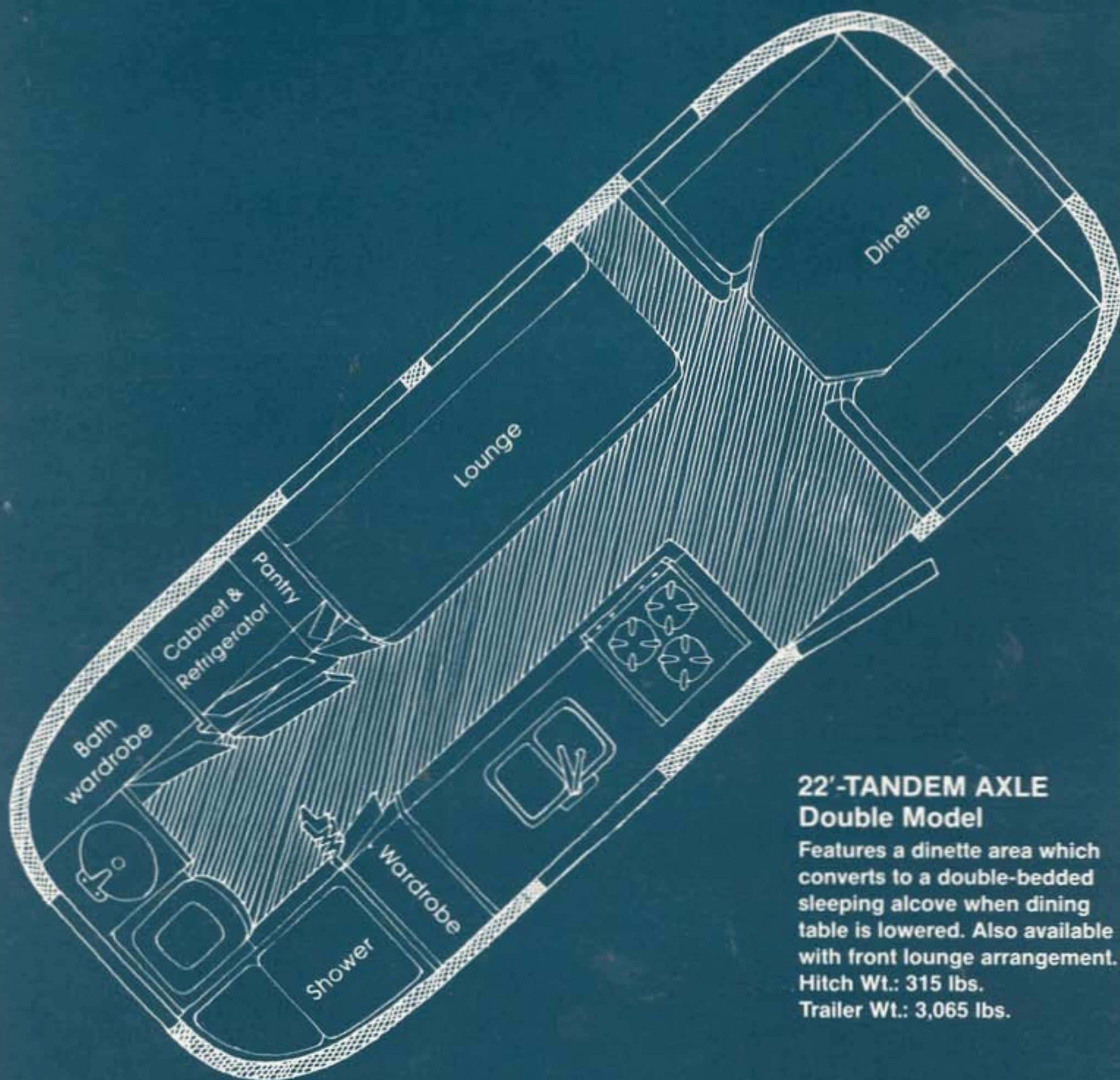

22'-TANDEM AXLE Double Model

Features a dinette area which converts to a double-bedded sleeping alcove when dining table is lowered. Also available with front lounge arrangement. Hitch Wt.: 315 lbs. Trailer Wt.: 3,065 lbs.

Note: All hitch weights and trailer weights quoted are for standard equipped models, ready for delivery. Not included is the weight of water, butane or personal belongings carried in the trailer.