

ability and cost aspects enter the picture. This contrasts with most other trailer manufacturers, who tend to think about livability and cost first, then consider how well the unit will tow. In other words, Airstream puts the emphasis on the "travel" in travel trailer, and it shows—both in the results of the design and in the price (base \$23,744, test trailer \$26,262).

The floorplan is basically designed for two people, but its spacious interior makes good use of its rather modest overall size. The layout in front is classic Airstream, with a sofa across the front and a folding table hinged at the wall between the sofa and the curbside door. The table is a two-piece one, with hinges in the middle, so it can be used for two when folded, or opened to provide room for four. We used a wooden folding chair that we brought along to make dining more comfortable. Folding chairs are required to take full advantage of the table's seating capacity. One or two people can sit on the sofa on one side of the table for meals, but a third person will need a chair to sit on the other side. We left the table up for travel and the folding chair in place.

Like everything else in the trailer, the chair was always in place after a day of driving, which confirms how smoothly this trailer rides.

The kitchen counter, with its stainless-steel sinks, four-burner stove and oven, is on the streetside just behind the sofa. The generous counter space is further increased by a flip-up extension. Galley storage is ample, well-positioned and nicely finished. In addition to the storage overhead—plus storage under the sink, stove and refrigerator—four good-size drawers are positioned between the sink and stove. The 6-cubic-foot refrigerator is across the aisle from the counter, making for a compact but very workable galley area.

Loss of vertical storage space in the overhead cabinets is a drawback of Airstream's rounded exterior shape. This is most noticeable in the galley. As one former Airstream owner pointed out when looking at the test trailer, "You can't even put a box of cereal upright up there." But my wife worked around this by putting those foods that come in tall boxes into different containers.

The couch, table and galley make

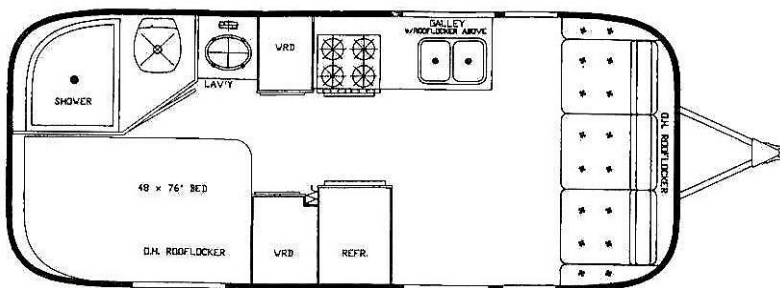

The fold-down table, located on the wall between the sofa and the curbside door, can be used as a desk or as a dining table for up to four people. Access to and egress from the corner bed require some agility of the inside sleeper.

AIRSTREAM 21' SPECIFICATIONS

Ext length	21'10"
Ext width	8'
Ext height	9'6"
Int width	7'7"
Int height	6'6"
Freshwater cap	50 gal
Black-water cap	23 gal
Gray-water cap	35 gal
LP-gas cap	15 gal
Hot-water cap	6 gal
Construction	Aluminum
Insulation	Fiberglass
Refrigerator	6 cu ft
Furnace	30,000 BTU
Toilet	Freshwater
Air-conditioner	13,500 BTU
Water-system type	Demand
Converter	50 amp
Battery (2)	105 amp-hrs
Tire size	ST215/75R14
Tire rating	C, 1870 lbs @ 50 psi
Brakes	Drum
Suspension	Independent rubber torsion

Wet Weights

(Water and propane tanks full; no supplies or passengers)

Total	4230 lbs
Hitch	620 lbs
Axle(s)	3610 lbs
Gvwr*	5500 lbs
Gawr**	5200 lbs

Owner may add up to 1270 pounds in weight of supplies to trailer equipped as test unit without violating trailer manufacturer's maximum gvwr.

Pricing

Base sugg. retail price	\$23,744
Price as tested	\$26,262

*Gross vehicle weight rating
**Gross axle weight rating

the front half of the trailer a daytime area, while the bed and bath in back complete the accommodations. A pair of small wardrobes are positioned on either side: one next to the refrigerator and the other just across the aisle, next to the stove. Both wardrobes feature cedar panels and handy lights that are switched on when the doors are opened.

The double bed is squeezed into the rear corner on the curbside. While the thick foam mattress is firm and comfortable for sleeping and the 48 x 77-inch bed is adequate for two, getting in and out of it requires some acrobatics. Since the bed is enclosed completely on two sides and partially on the other two, there is only the one

21' A/S 1992 Photos by Glenn Hamanuchi