

Model 34A Side Lounge  
(Excella Only)

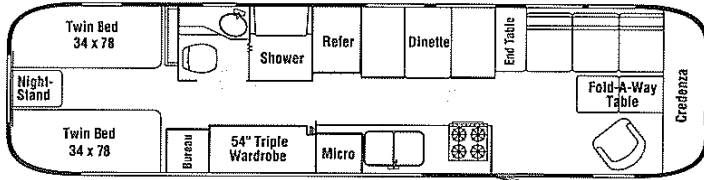

Model 34J Side Lounge  
(Excella Only)

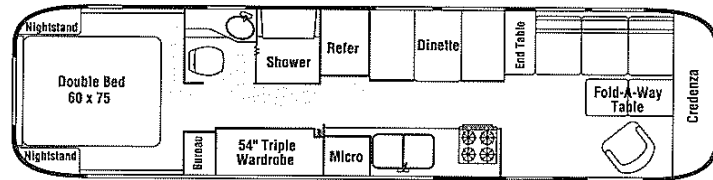

Model 34A (Excella & Limited)

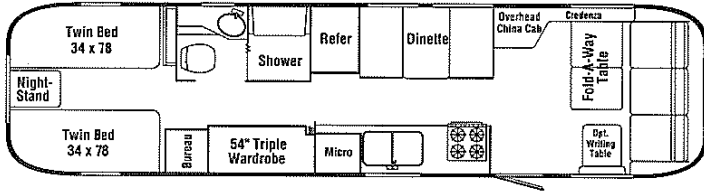

Model 34J (Excella & Limited)

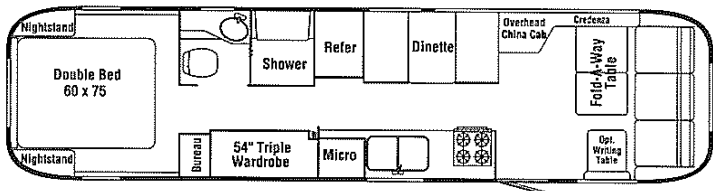

Model 32K

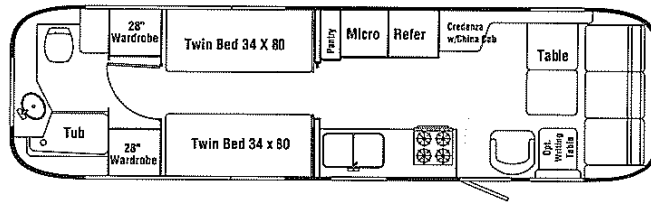

Model 25

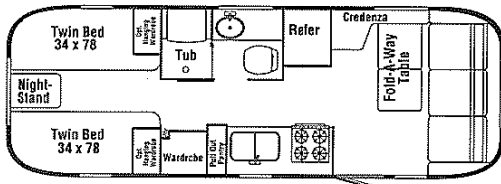

Model 29

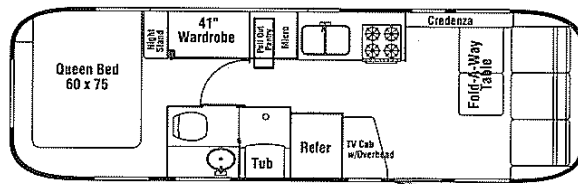

Model 32M

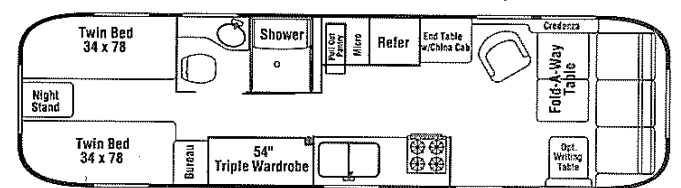
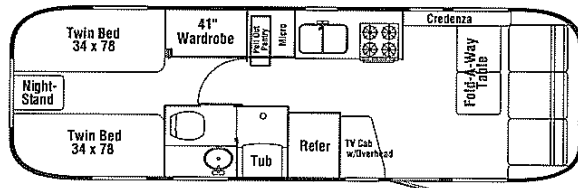
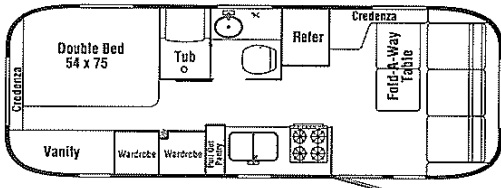
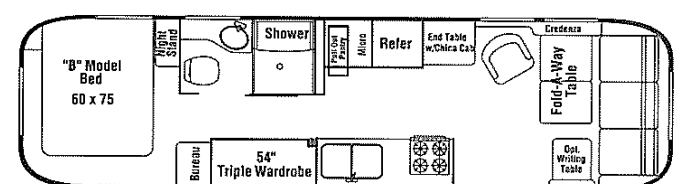

### Optional Features\*

Chassis	Excelsa						Ltd.
	M'	K'	M'	K'	M'	K'	
	25'	29'	32'	32'	34'	34'	
Aluminum Wheels	0	0	0	0	0	0	S
Radial Spare	0	0	0	0	0	0	0
Spare Tire Bracket (Ltd. w/Winch)	0	0	0	0	0	0	S
Electric Hitch Jack	0	S	S	S	S	S	S
<b>Exterior Features</b>							
Polished Bumper w/Extruded Lid	0	0	S	S	S	S	S
LPG Bottle Cover	0	0	S	S	S	S	S
Patio Awning w/Center Support	0	0	0	0	0	0	S
2nd Battery	0	0	S	S	S	S	S
Solar Battery Charger	0	0	0	0	0	0	0
Wrap Protectors	0	0	0	0	0	0	0
Stone Guard - 3 pc.	0	0	0	0	0	0	S
Solar Grey Rear Panoramic Windows	0	0	0	N/A	0	0	0
Vista View Windows	N/A	N/A	0	0	0	0	0
Stacked Window - Forward of Door	0	0	0	S	0	0	0
Keyless Entry	N/A	N/A	0	0	0	0	S
Rear Entry Door - N/A Twins	N/A	N/A	0	N/A	0	0	0
Exterior Lighting Pkg.	0	0	S	S	S	S	S
40# Aluminum LPG Tanks	0	0	0	0	0	0	S
30# Aluminum LPG Tanks	0	0	S	S	S	N/A	N/A
<b>Interior Features</b>							
PVC Easy Lift Blinds	0	0	S	S	S	N/A	N/A
Pull Shades	0	0	0	0	0	0	N/A
Excelsa "1000" Pkg.	0	0	0	0	0	0	S
Deluxe Foam Mattress	0	0	0	0	0	0	0
Wood Tambour Spice Rack	0	0	S	S	S	S	S
Corian Type Galley Top	N/A	N/A	N/A	N/A	0	0	0
Oak Raised Panel Refrigerator Insert	0	0	0	0	0	0	S
Planked Oak Galley Flooring	0	0	0	0	0	0	0
Cocktail Chair	0	0	S	S	S	S	S
Roadside Lounge w/Front Credenza	N/A	N/A	N/A	N/A	0	N/A	N/A
2nd Cocktail Chair	N/A	N/A	0	0	N/A	N/A	N/A
Writing Table	0	0	0	0	0	0	0
Walnut Wood Interior	N/A	N/A	N/A	N/A	N/A	0	0
<b>Appliances</b>							
4-Burner Cook Top w/Pan Drawer	N/A	0	0	0	0	0	0
Dual Furnace(1-30,000, 1-25,000 BTU)	N/A	N/A	N/A	N/A	0	0	0
Ceiling Vent Fans	0	0	S	S	S	S	S
Bedroom Attic Fan - 12 Volt	N/A	0	0	0	0	0	0
Vacuum Cleaner	0	0	0	0	0	0	S
Food Center	N/A	N/A	0	0	0	0	S
Microwave	0	0	S	S	S	S	S
Convection Microwave	N/A	0	0	0	0	0	0
Deluxe Monitoring System (N/A w/o Alum. LPG Tanks)	0	0	S	S	S	S	S
6 Gallon Water Heater w/Elec. Ignition	0	0	S	S	S	S	S
Insta-Hot Water Tap	0	0	0	0	0	0	S
Deluxe AM/FM/Cassette Radio	0	0	0	0	0	0	S
Cable TV, Ant. Amp., Telephone Jack	0	0	0	0	0	0	S
Fluorescent Lights	0	0	0	0	0	0	0

### Weights & Lengths

LENGTH	MODEL	DRY WEIGHT	HITCH WEIGHT	ADDITIONAL ALLOWABLE	ACTUAL LENGTH
25'	Excelsa	5100#	700#	1700#	25'11"
29'	Excelsa	5600#	700#	1200#	29'2"
32'M	Excelsa w/o Dinette	6300#	700#	2000#	32' 9"
32'K	Excelsa w/Rear Bath	6350#	700#	1950#	32' 9.5"
34'	Excelsa	6900#	800#	2000#	35'1"
34'	Limited	7300#	800#	1600#	35'1"

### Dimensions

Hitch Ball Height	1' 6 3/4"
Exterior Width	7' 11 1/2"
Exterior Height	With A/C 9' 7 1/2"
Interior Height	With A/C 6' 3 1/2"
Tire Size	ST225/75R15

### Capacities

SIZE/MODEL	FRESH WATER TANK	MAIN HOLDING TANK	AUXILIARY HOLDING TANK
	25',29',32M' & 34'	50 gal.	30 gal.
32'K	50 gal.	32 gal.	20 gal.

### EXCELSA 1000 PACKAGE

Exterior "1000" Casting  
 Easy-Lift PVC Blinds  
 (Bedroom, Galley, Bath)  
 Entrance Mat  
 Tamarak Level  
 Screen Door Guard  
 Wood Blinds (Lounge & Dinette)  
 Zip Dee Chairs (2)  
 "Limited" Clock  
 Alarm Clock  
 Appliance Garage (34' Only)  
 High Riser Faucet  
 13,500 A/C W/Heat Strip & Electronic Controls  
 Upgrade Fabric

O=Optional, S=Standard, N/A=Not Available  
 \*32'M = Without Dinette; 32'K = Rear Bath

\*Not all standard features and options are available on all models. See your dealer for availability of specific options.

If you are in Jackson Center, Ohio, be sure to take the Airstream factory tour.  
 For more information call 513-596-6111.

### Standard Features

#### Chassis/Exterior

Aluminum Wheels (Std. 34' LTD)  
 Spoked Steel Wheels w/Trim Ring (N/A 34' LTD)  
 Radial Tires  
 Electric Drum Brakes-12"  
 Retractable Stabilizer Jacks W/Pads  
 Aluminum Step W/Extension  
 Keyless Dead Bolt (Std. 34' LTD)  
 Solar Grey Front Panoramic Windows  
 Door Window, Solar Grey  
 Center Brake Light  
 Manual Wind Up Power Cord On Slide Out Tray  
 Larger Exterior Access Doors  
 (Twin Beds Only; N/A 25')

#### Interior

Quilted Bedspreads And Pillow Covers  
 Innerspring Mattress  
 Cedar Lined Wardrobes  
 Hardwood Framed Hinged Wardrobe  
 Doors with Mirror  
 Zip Dee Chair Storage (N/A 25')  
 Sink Covers - 2  
 Double Porcelain Sinks (32' & 34', N/A  
 w/Corian Galley Top)  
 Double Stainless Steel Sinks (29' & 25',  
 Mandatory w/Corian Top)  
 Bi-Fold Range Cover  
 76" Front Deluxe Flip Lounge w/R.S. Credenza  
 Living Room Lift-up Table  
 Pull-Out Pantry

#### Appliances

13,500 BTU Roof Air w/Heat Strip (Manual)  
 35,000 BTU Furnace (32' & 34')  
 30,000 BTU Furnace (25' & 29')  
 4 Burner Range w/Oven  
 Combination Range Exhaust Fan  
 and Monitor Panel  
 Refer 8 cu. ft. (6 cu. ft. 25' only)

#### Systems/Electrical

LP Pressure Gauge in Refrigerator Compartment  
 Smoke Detector  
 AM/FM/Cassette Radio  
 Manual TV Antenna w/Splitter  
 TV Jack w/2 - 12 Volt Outlets  
 7-Way Trailer Plug  
 50 AMP Converter  
 Water Pump Switch (Galley, Bath)  
 12 Volt Battery Disconnect  
 Pre-Wire For Solar Battery Charger  
 Automatic 2-Stage Regulator  
 Water Heater By-Pass Kit  
 Black Water Tank Flush