

As a part of Thor Industries, Inc., the second largest manufacturer of recreational vehicles, we have the resources to maintain the standards of engineering and manufacturing excellence that Airstream has set over the years. The result is your assurance of solid value when you invest in a Land Yacht motor home. See your dealer to see for yourself why you should own a Land Yacht.

GENERAL SPECIFICATIONS

Dimensions & Weights

	30'	33'	36'	34' Pusher
Length	31' 2"	33' 5"	36'	35' 5"
Interior Width	7' 6 1/2"	7' 6 1/2"	7' 6 1/2"	7' 6"
Interior Height	6' 6"	6' 6"	6' 6"	6' 7"
Exterior Height with Air	10' 2"	10' 2"	10' 2"	10' 3"
Rear Overhang	11' 9"	11' 9"	11'	10' 4"
Wheel Base	109"	208"	208"	228"
GVWR	16,000	16,000	18,000	19,500
ASW Weights*	12,580#	13,900#	15,000#	17,100#
Exterior Storage Volume	65 cu. ft.	65 cu. ft.	80 cu. ft.	46 cu. ft.

Capacities

	30'	33'	36'	34' Pusher
105# LPG Tank	Std.	Std.	Std.	Std.
Fuel Tank (gallons)	80	80	80	80
Fresh w/Drain (gallons)	80 (Dbl) 60 (Twin)	80 (Dbl) 60 (Twin)	80 (Dbl) 60 (Twin)	60 (Dbl)
Grey Water Tank (gallons)	36	36	40	39
Black Water Tank (gallons)	29	29	45	39

Chassis

Model 30'

454 cu. in. Chevrolet

Model 33'

454 cu. in. Chevrolet with Air-Ride

Model 36'

454 cu. in. Chevrolet with Henschen Composite Multi-Tag Axle

Model 34' Pusher

Spartan 2230 with Cummins 190 HP Engine and Allison AT542 Transmission on 34P (230 HP Cummins w/Allison MD 3060, Opt.)

*Approximate Standard Weight including fuel (w/o water)
Optional equipment may increase weight.

Shown with optional twin beds—available on 30', 33' & 36'

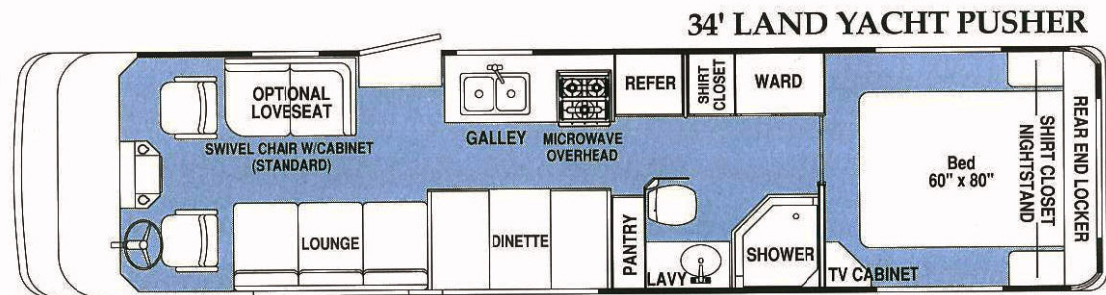
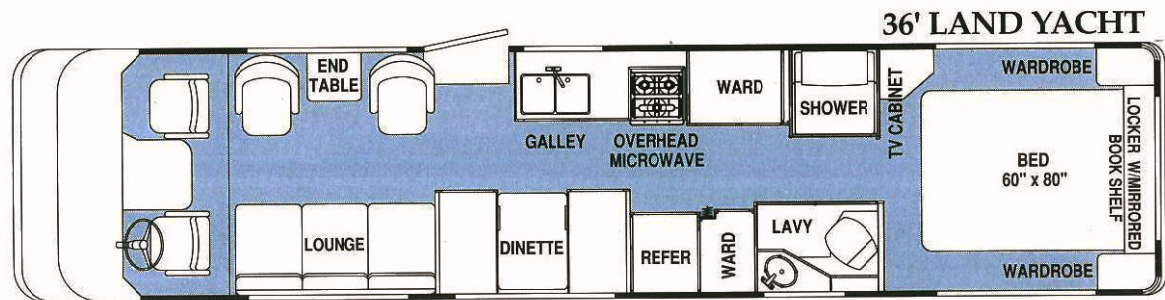
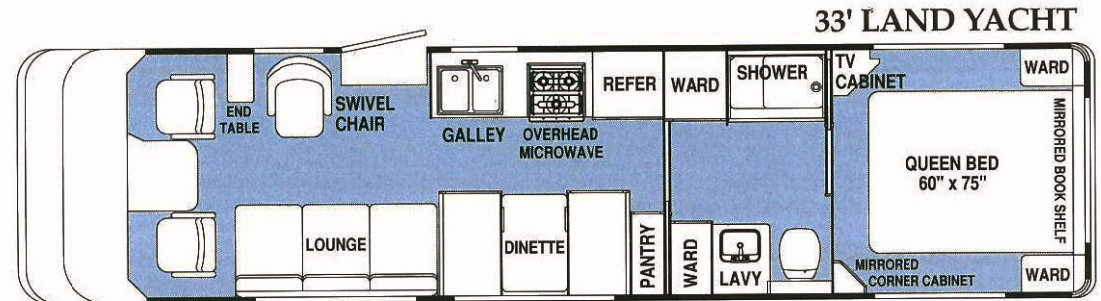
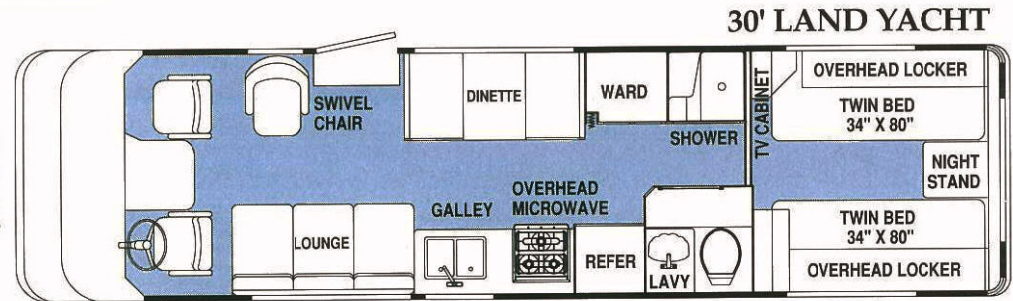

With Airstream's sixty years of experience building vehicles that have become American institutions, you can feel confident your Airstream Land Yacht is designed for truly outstanding livability. Land Yacht floorplans represent the ultimate in space planning for comfort and convenience, with truly impressive storage capacity and many standard features that are expensive options on other motor homes.