

winds or blasts of air from passing traffic, either coming or going. A slight nudge is the maximum effect sensed from the largest trucks under the worst wind conditions.

The presence of a tag axle on the Classic 360 no doubt contributes to its on-road stability. The Henschen tag axle features a rubber-torsion independent suspension setup and



The television is easily watched from any spot in the living area.



Open and airy, the master bedroom is reminiscent of a luxurious stateroom.



A linen closet and three medicine cabinets grace the commodious bathroom.

Airstream 36' Specifications

Performance

Fuel consumption*	8.1 mpg
Acceleration time	
0-60 mph	32.6 sec
40-60 mph	19.0 sec

*Fuel consumption recorded at 55 mph, 600 feet elevation, hilly terrain. Ambient temperature 45 degrees F. Uphill test in second gear, 6 percent grade, full throttle.

Chassis

Manufacturer	Chevrolet
Engine	7.4 (454-cid) V-8
Horsepower	230 @ 3600 rpm
Torque	385 @ 1600 rpm
Transmission	4-spd auto w/OD
Axle ratio	4.56:1
Tire size	8R19.5
Load range	D; 2800 lb single/ 2700 lb dual @ 70 psi cold
Wheelbase	208"
Brakes	Disc front/rear
Suspension	Coil-spring front/ leaf-spring rear with tag axle
Cooling system	HD
Fuel cap	80 gal

Coach

Ext length	36'2"
Ext width	7'11"
Ext height	10'4"
Int width	7'6 1/2"
Int height	6'6 1/2"
Frame construction	Aluminum
Insulation	Fiberglass
Freshwater cap	80 gal

Sink/shower holding cap	40 gal
Waste-water holding cap	45 gal
Hot-water cap	6 gal
Propane cap	26 gal
Water-system type	Demand
Furnace (2)	31,000/16,000 BTU
Air-conditioner (2)	13,500 BTU
Refrigerator	8 cu ft
Toilet	Freshwater
Converter	50 amp
Battery (2)	110 amp-hr
Generator	7.0 kw
Base sugg retail price	\$120,526
Price as tested	\$123,408

Wet Weight

(Water, propane, fuel tanks full; no passengers or supplies)

Front axle	4,500 lb
Rear axle	10,850 lb
Right side	7,520 lb
Left side	7,830 lb
Total	15,350 lb

Chassis Ratings

Front gawr	5,500 lb
Rear gawr	10,500 lb
Tag axle	3,000 lb
Gvwr**	18,000 lb

**Owner may add up to 2650 pounds in weight of passengers and supplies to motorhome test coach without violating chassis maximum gvwr.

Gawr: gross axle weight rating
Gvwr: gross vehicle weight rating

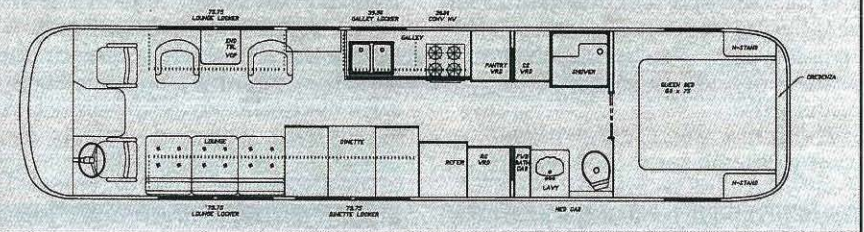

the usual Airstream air-ride system, with air bags on both rear axles. Ride-height levelers sense the axle's positions relative to each other and adjust the air-bag pressure to ensure the maximum traction is always available at the drive axle. An on-board compressor provides a steady supply of air for the suspension system, and a dash-mounted gauge allows for easy system monitoring.

Use of the tag axle allows Airstream to re-rate the Chevy chassis to 18,000 pounds gross vehicle weight rating (gvwr), which leaves a whopping 2650 pounds of payload capacity.

Off the interstate, we followed the two lanes to some of southern Indi-

ana's most remote and beautiful parks. When traveling backroads to the Yellowwood State Forest, for example, we pushed the Classic suspension to the ultimate test on washboard gravel roads. The coach was every bit as steady and secure feeling as it had been on the freeway.

From the driver's standpoint, my B-17 copilot's fantasy isn't too far off. The wraparound windshield allows for great visibility and the mirrors are easy to view through the large side windows. The cockpit is functional and straightforward with easily readable gauges. All controls are accessible when under way. The

more on page 70