

**LIGHTWEIGHT.**

**STREAMLINED.**

**FUEL EFFICIENT.**

Founder Wally Byam knew that a rounded, low-profile shape would make towing easier and more stable. And he knew that aluminum would make his trailers as light as possible.

The successful combination of shape and lightweight design has made the Airstream travel trailer world-renowned for its superior structured integrity. That's because the Airstream employs semi monocoque construction, using a riveted inner and outer layer of aluminum stretched over the frame. This way, the skin itself becomes a working part of the integral structure.

Hand-built with a craftsman's attention to detail, the Airstream offers unmatched durability and strength for its weight. Just ask one of the more than 100,000 Airstream owners!



▼ 27FB Signature Series



### **SLEEK CONTEMPORARY SOPHISTICATION INTERNATIONAL SIGNATURE SERIES**

From award-winning architect and designer Christopher C. Deam, comes the Signature Series CCD. Inspired by the desire to visually echo the reflective exterior, its interior design combines polished aluminum with luxurious Wenge laminate.

Featuring vista view and panoramic windows, the Signatures Series truly brings the outside in. At night, strategically placed recessed halogen lighting sparkles like starlight across the interior aluminum skin. Every color, shape, surface, and texture contributes to an atmosphere of relaxed modernism. A perfect balance of luxury and streamlined efficiency gives the Signature Series its unmatched international flair.

With six floor plans to choose from, the Signature Series CCD offers the discriminating consumer a wide array of choices for a wide array of destinations. Whether you're taking a road trip to Palm Springs or creating a unique backyard guest house, the Signature Series makes a statement.

▼ 23 Signature Series with Paprika decor



▼ 27FB Signature Series galley area



Airstream, Inc.  
419 West Pike Street  
Jackson Center, OH 45334 USA  
937-596-6111  
[www.airstream.com](http://www.airstream.com)

### 16 INTERNATIONAL SIGNATURE SERIES

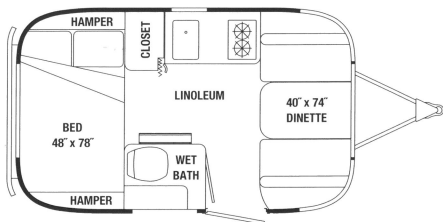

### 19 INTERNATIONAL SIGNATURE SERIES

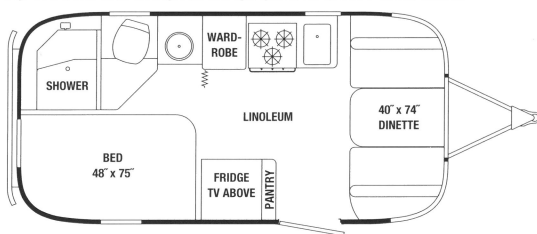

### 23D INTERNATIONAL SIGNATURE SERIES

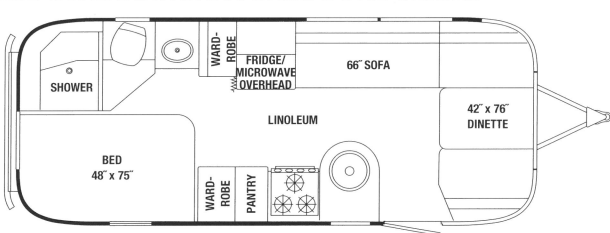

### 25FB INTERNATIONAL SIGNATURE SERIES

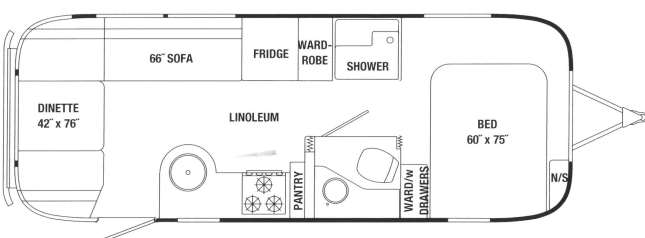

### 27FB INTERNATIONAL SIGNATURE SERIES

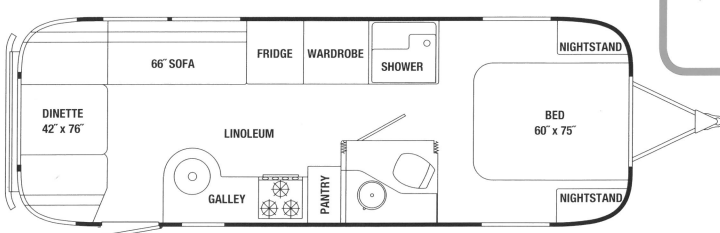

### 28 INTERNATIONAL SIGNATURE SERIES

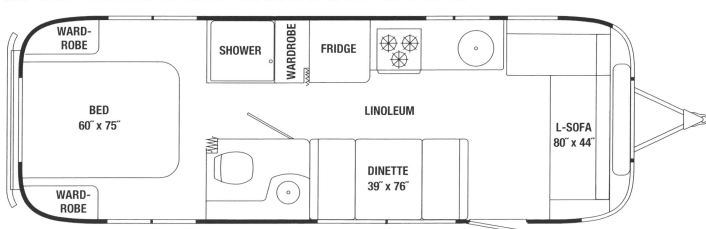

### INTERNATIONAL SIGNATURE SERIES TECHNICAL SPECIFICATIONS

|  | 16      | 19      | 23D     | 25FB    | 27FB    | 28      |
|--|---------|---------|---------|---------|---------|---------|
| Exterior Length  | 16' 7"  | 19' 2"  | 23'     | 25' 11" | 28'     | 27' 11" |
| Width Exterior   | 8'      | 8'      | 8'      | 8' 5.5" | 8' 5.5" | 8' 5.5" |
| Width Interior   | 7' 7"   | 7' 7"   | 7' 7"   | 8' 1"   | 8' 1"   | 8' 1"   |
| Height Exterior w/ A/C   | 9' 4"   | 9' 5"   | 9' 5"   | 9' 7"   | 9' 7"   | 9' 7"   |
| Height Interior w/ A/C   | 6' 4.5" | 6' 4.5" | 6' 4.5" | 6' 5"   | 6' 5"   | 6' 5"   |
| Hitch Ball Height  | 18"     | 17.25"  | 17.75"  | 17.75"  | 17.75"  | 17.75"  |
| Hitch Weight (w/ LP and w/o options, water & cargo) (lbs.)     | 459     | 550     | 720     | 833     | 770     | 950     |
| Unit Base Weight (w/ LP and w/o options, water & cargo) (lbs.) | 3,261   | 3,763   | 4,701   | 5,552   | 5,764   | 5,853   |
| Gross Vehicle Weight Rating                                    | 4,300   | 4,500   | 6,000   | 7,300   | 7,600   | 7,300   |
| Net Carrying Capacity (NCC=GVWR-UBW) (lbs.)                    | 1,039   | 737     | 1,299   | 1,748   | 1,836   | 1,447   |
| Fresh Water Tank w/ drain valve (gal.)                         | 23      | 23      | 30      | 39      | 39      | 39      |
| Black Water Tank (gal.)  | N/A     | 18      | 18      | 39      | 39      | 35      |
| Gray Water Tank (gal.)   | N/A     | 21      | 21      | 37      | 37      | 37      |
| Combination Black & Gray Tank (gal.)                           | 21      | N/A     | N/A     | N/A     | N/A     | N/A     |
| Water Heater w/ electronic ignition (gal.)                     | 6       | 6       | 6       | 6       | 6       | 6       |
| A/C w/ heat pump (strip on 16') (BTU)                          | 11,000  | 13,500  | 13,500  | 13,500  | 15,000  | 15,000  |
| Furnace (BTU)  | 12,000  | 16,000  | 25,000  | 25,000  | 25,000  | 30,000  |
| LPG (2 steel tanks) (lbs.)                                     | 40      | 60      | 60      | 60      | 60      | 60      |
| Deep Cycle Battery (lead acid) Group 24                        | 1       | 2       | 2       | 2       | 2       | 2       |
| Sleeping Capacity  | 2-3     | 2-4     | 2-5     | 2-5     | 2-5     | 2-6     |

#### DECORS:

Cilantro

Paprika

Yellowstone

Taupe Ultraeather

Product information, specifications, and photography in this brochure were as accurate as possible at time of printing. Photographs may contain some features that are optional on your vehicle. Since we continually strive to improve our products, actual products may differ. Prices and specifications are subject to change without notice. All capacities are approximate and dimensions are nominal. Some features or options may be different or unavailable in Canada.

Vehicle Loading - Every effort has been made to provide the greatest number of options for the recreation vehicle owner. Along with these choices comes the responsibility to manage the loads that are imposed by the choices so that they remain within the manufacturer's specified chassis weight limits. Do not overload the recreation vehicle.

Dry Weights - Based on standard features; optional equipment not included. Net carrying capacity (NCC) determined by subtracting unloaded vehicle weight (UVW) from gross vehicle weight (GVWR) and includes fluids, options, and cargo. Liquid capacities and weights are approximations only.

Warning - This information is intended as a guide only. Weights of individual vehicles may vary. Consult your owner's manual for complete loading, weighing, and towing instructions.