

LIGHTWEIGHT.

STREAMLINED.

FUEL EFFICIENT.

Founder Wally Byam knew that a rounded, low-profile shape would make towing easier and more stable. And he knew that aluminum would make his trailers as light as possible.

The successful combination of shape and lightweight design has made the Airstream travel trailer world-renowned for its superior structured integrity. That's because the Airstream employs semi monocoque construction, using a riveted inner and outer layer of aluminum stretched over the frame. This way, the skin itself becomes a working part of the integral structure.

Hand-built with a craftsman's attention to detail, the Airstream offers unmatched durability and strength for its weight. Just ask one of the more than 100,000 Airstream owners!



Airstream, Inc.
419 West Pike Street
Jackson Center, OH 45334 USA
937-596-6111
www.airstream.com

▼ 22FB Sport



LIGHTWEIGHT AFFORDABILITY

Lightweight and nimble, the Airstream Sport line sets a new standard for ease of use – perfect for those who want to just hitch-up and go. Airstream Sport travel trailers are true premium compact trailers that let you live large. Smart floorplans maximize space and minimize waste in two easy-to-handle lengths. Spacious and airy with its own lights, water, shower and fuel for cooking – plus more creature comforts than some trailers twice their size have – the Airstream Sport offers the best travel trailer investment available.

So choose your floorplan, choose the styling, then choose a destination. Whether it's a week of canoeing in Minnesota's Boundary Waters or three nights of music at California's Monterey Jazz Festival, you'll enjoy all the comforts of home no matter how far the road takes you. The Airstream Sport offers nothing less than a personal declaration of independence. So get out there – your adventure awaits!

▼ 16 Sport back-to-front in Mochablue decor



▼ 16 Sport front-to-back in Mochablue decor



SPORT TECHNICAL SPECIFICATIONS

	16	22FB
Exterior Length	16' 4"	21' 8"
Width Exterior	8'	7' 3.25"
Width Interior	7' 7"	6' 11.75"
Height Exterior w/ A/C	9' 4"	8' 11"
Height Interior w/ A/C	6' 4.5"	6' 3"
Hitch Ball Height	18"	17.25"
Hitch Weight (w/ LP & w/o options, water & cargo) (lbs.)	446	393
Unit Base Weight (w/ LP & w/o options, water & cargo) (lbs.)	2,897	3,594
Gross Vehicle Weight Rating (U.S.) (lbs.)	3,500	4,500
Net Carrying Capacity (NCC=GVWR-UBW) (lbs.)	603	906
Fresh Water Tank w/ drain valve (gal.)	23	20
Black Water Tank (gal.)	N/A	18
Gray Water Tank (gal.)	N/A	24
Combination Black & Gray Tank (gal.)	21	N/A
Water Heater w/electronic ignition (gal.)	6	6
A/C (BTU)	11,000	13,500
Furnace (BTU)	12,000	12,000
LPG (2 - 20 lb. steel tanks) (lbs.)	40	40
Deep Cycle Battery (lead acid) Group 24	1	1
Sleeping Capacity	2-3	2-4

DECORS: Product information, specifications, and photography in this brochure were as accurate as possible at time of printing. Photographs may contain some features that are optional on your vehicle. Since we continually strive to improve our products, actual products may differ. Prices and specifications are subject to change without notice. All capacities are approximate and dimensions are nominal. Some features or options may be different or unavailable in Canada.

Oatmeal

Mochablue

Cinnabar

Sharksfin

Vehicle Loading - Every effort has been made to provide the greatest number of options for the recreation vehicle owner. Along with these choices comes the responsibility to manage the loads that are imposed by the choices so that they remain within the manufacturer's specified chassis weight limits. Do not overload the recreation vehicle.

Dry Weights - Based on standard features; optional equipment not included. Net carrying capacity (NCC) determined by subtracting unloaded vehicle weight (UVW) from gross vehicle weight (GVWR) and includes fluids, options, and cargo. Liquid capacities and weights are approximations only.

Warning - This information is intended as a guide only. Weights of individual vehicles may vary. Consult your owner's manual for complete loading, weighing, and towing instructions.



▲ 22FB Sport back-to-front in Mochablue decor

16 SPORT

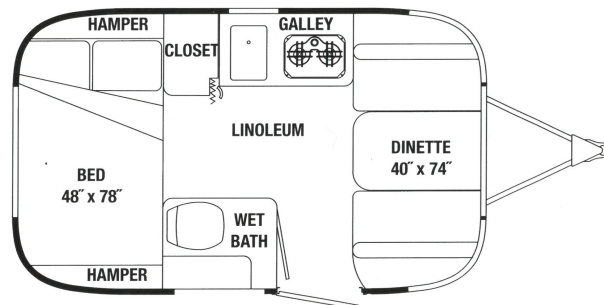

22FB SPORT

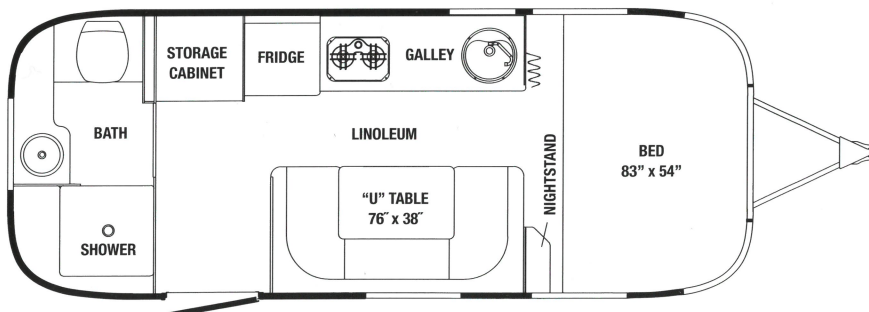

▲ 22FB Sport in Mochablue decor front-to-back