

adventure, inspired by  
**AIRSTREAM**

*Classic*



30 Classic Limited

## Traditional Styling Without Compromise

Forget what you thought or imagined luxury, comfort and practicality could be in a travel trailer. Designed for long-term or full-time use, the Airstream Classic Limited takes it a step farther with traditional styling that never forces you to compromise. The flagship of the Airstream travel trailer fleet, the Classic Limited line offers elegant floorplans with outstanding storage capacity, residential-style galleys, spacious living areas and private sleeping quarters.

Inside you'll find generously appointed interiors with real hickory hardwood cabinetry, Corian® countertops, Moen® fixtures, plush furnishings and so much more. The Airstream Classic Limited is classic Airstream – the perfect expression of our commitment to design, innovation and quality. So go ahead and leave home without leaving behind the comforts of home. No corners have been cut and nothing spared in creating a living space that lets you entertain in style, dine in comfort and relax in peace.

No other travel trailer comes close to creating this luxurious residential environment. To that we added exterior storage, smartly placed hookups and easy-out awnings that expand living area even further into the great outdoors. So no matter where you pursue your next adventure, Airstream Classic Limited travel trailers make you feel right at home – which, of course, you are.



30 Classic Limited with Ultraleather sofa option in Cocoa decor



30 Classic Limited front-to-back in Cocoa decor



**Lightweight.  
Streamlined.  
Fuel Efficient.**

Founder Wally Byam knew that a rounded, low-profile shape would make towing easier and more stable. And he knew that aluminum would make his trailers as light as possible.

The successful combination of shape and lightweight design has made the Airstream travel trailer world-renowned for its superior structural integrity. That's because the Airstream employs semi-monocoque construction, using a riveted inner and outer layer of aluminum stretched over the frame. This way, the skin itself becomes a working part of the integral structure.

Hand-built with a craftsman's attention to detail, the Airstream offers unmatched durability and strength for its weight. Just ask one of the more than 100,000 Airstream owners!





## Technical Specifications

### 27FB Classic Limited **Q**

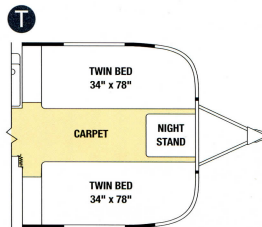
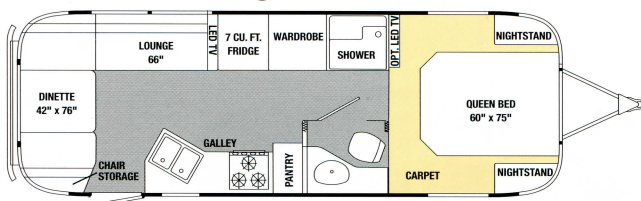

The 27FB Classic Limited offers two bedroom floorplan options:

- Q** Queen size bed with two nightstands
- T** Two twin size beds with nightstand & trunk storage

### 30 Classic Limited **Q**

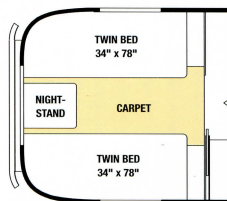
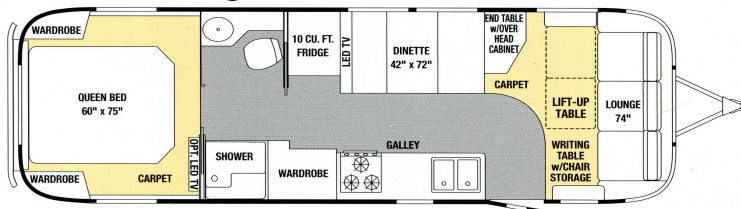

The 30 Classic Limited offers two bedroom floorplan options:

- Q** Queen size bed with two wardrobes
- T** Two twin size beds with nightstand & trunk storage

### 31 Classic Limited **Q**

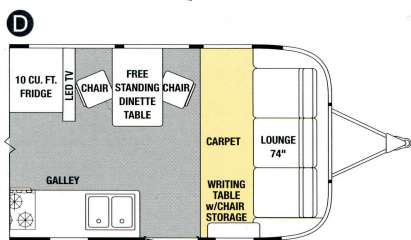
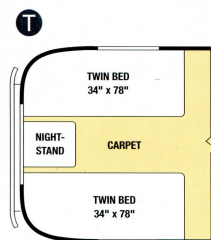
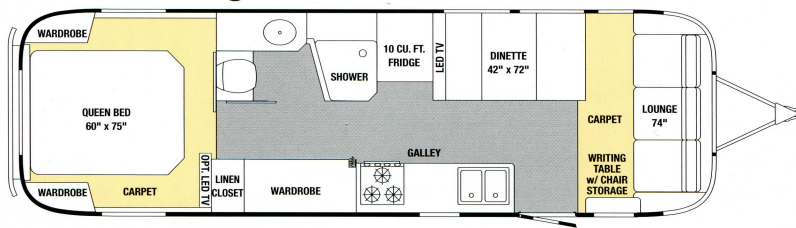

	<b>27FB</b>	<b>30</b>	<b>31</b>
Exterior Length	27' 9.5"	31'	31'
Width Exterior	8' 5.5"	8' 5.5"	8' 5.5"
Width Interior	8' 1"	8' 1"	8' 1"
Height Exterior w/ A/C	9' 7.5"	9' 7.5"	9' 7.5"
Height Interior w/ A/C	6' 5"	6' 5"	6' 5"
Hitch Ball Height	18.75"	18.75"	18.75"
Hitch Weight (w/ LP & w/o options, water & cargo) (lbs.)	792	773	805
Unit Base Weight (w/ LP & w/o options, water & cargo) (lbs.)	6,592	7,285	7,174
Gross Vehicle Weight Rating (U.S.) (lbs.)	9,000	10,000	10,000
Net Carrying Capacity (NCC=GVWR-UBW) (lbs.)	2,408	2,715	2,826
Fresh Water Tank w/drain valve (gal.)	54	54	54
Black Water Tank (gal.)	39	39	39
Gray Water Tank (gal.)	37	37	37
Water Heater gas/electric w/ DSI (gal.)	6	6	6
A/C w/heat pump (BTU)	15,000	15,000	15,000
Furnace (BTU)	30,000	34,000	34,000
LPG (2 - 40 lb. aluminum tanks) (lbs.)	80	80	80
Deep Cycle Battery (lead acid) Group 27	2	2	2
Sleeping Capacity	2-5	2-6	2-6

The 31 Classic Limited offers three floorplan options:

- Q** Queen size bed with two wardrobes
- T** Two twin size beds with nightstand & trunk storage
- D** Free standing dinette w/ two chairs

- Q** = Queen
- T** = Twin
- D** = Dinette

### Interior Decors

- Cocoa
- Praline
- Jade

**THOR**  
INDUSTRIES, INC.

Airstream, Inc.  
419 West Pike Street  
P.O. Box 629  
Jackson Center, OH  
45334 USA  
937-596-6111  
[www.airstream.com](http://www.airstream.com)

All content and images  
© Airstream 2011

CL 7.5k 03/11

Product information, specifications, and photography in this brochure were as accurate as possible at time of printing. Photographs may contain some features that are optional on your vehicle. Since we continually strive to improve our products, actual products may differ. Prices and specifications are subject to change without notice. All capacities are approximate and dimensions are nominal. Some features or options may be different or unavailable in Canada.

Vehicle Loading - Every effort has been made to provide the greatest number of options for the recreation vehicle owner. Along with these choices comes the responsibility to manage the loads that are imposed by the choices so that they remain within the manufacturer's specified chassis weight limits. Do not overload the recreation vehicle. Net carrying capacity is available for options, water, and carry-on cargo.

Warning - This information is intended as a guide only. Weights of individual vehicles may vary. Liquid capacities and weights are approximations only. Consult your owner's manual for complete loading, weighing, and towing instructions.