

When you're ready to take a break from the great outdoors, the Flying Cloud invites you inside with a flair of modern design. From fabrics to fixtures to cabinetry, the Flying Cloud line reflects your taste with clean, comfortable, contemporary styling throughout.

The right-sized travel trailer for an adventure, the Airstream Flying Cloud combines lightweight ruggedness with total practicality.

Advanced storage solutions and multi-functional workspaces make the Flying Cloud the perfect choice for extended travel or full-time use. With abundant floorplans and a variety of options, it's no wonder it has been one of Airstream's most popular models for decades.

So no matter if you're a first-time Airstreamer or seasoned veteran of the road, the Flying Cloud gets you on your way to your next adventure in contemporary style, luxurious comfort and long-lasting value.



Flying Cloud Black Ultraleather Option



19 Flying Cloud Back to Front in Mica Décor



20 FLYING CLOUD

Flying Cloud Floorplans

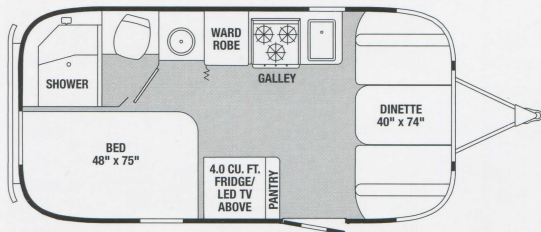

19 Flying Cloud

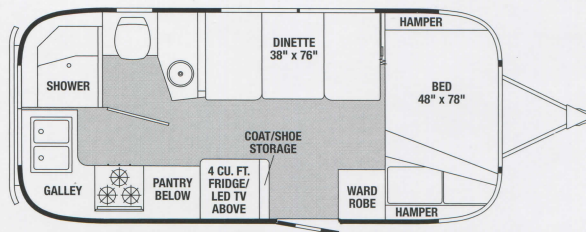

20 Flying Cloud

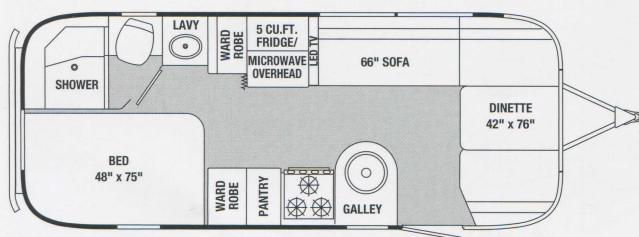

23D Flying Cloud

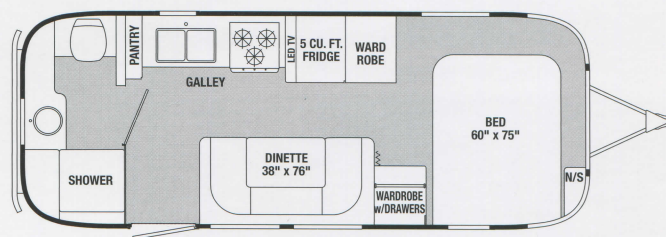

23FB Flying Cloud

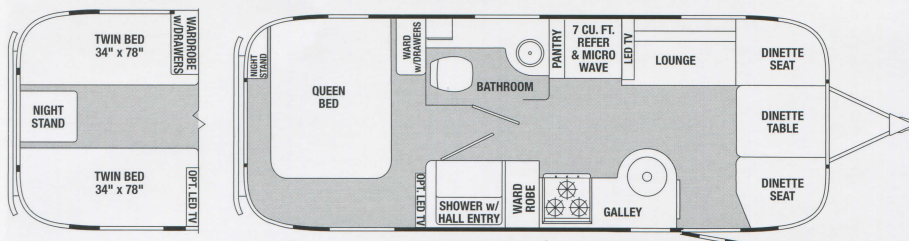

25 Flying Cloud

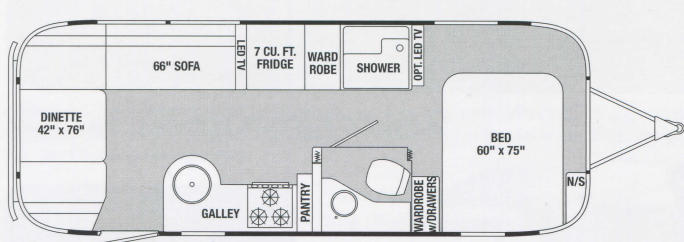

25FB Flying Cloud

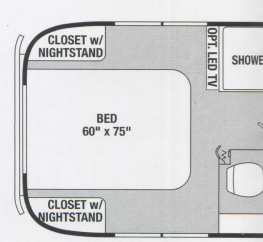
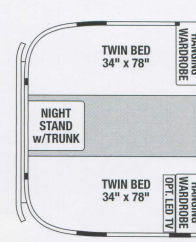
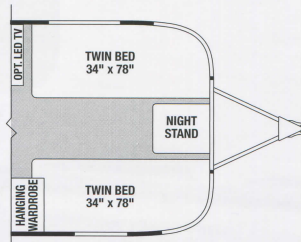

28 Flying Cloud

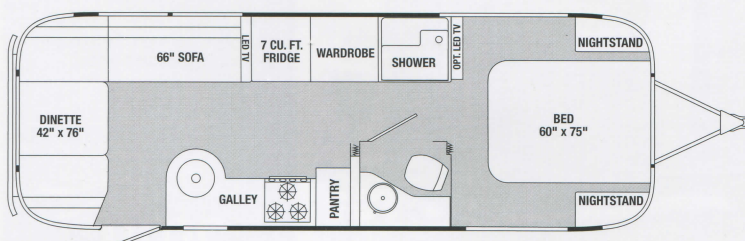

27FB Flying Cloud

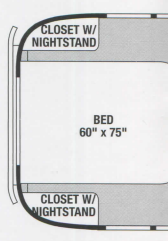
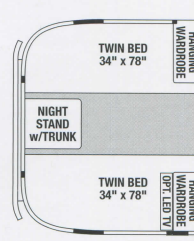
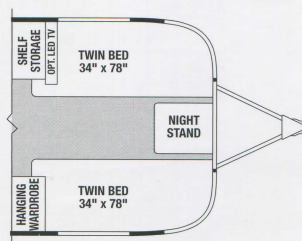

30 Flying Cloud

Interior Décor's

- Mica
- Golden Night
- Golden Ultraleather with Mica
- Golden Ultraleather with Golden Night
- Black Ultraleather with Golden Night



FLYING CLOUD TECHNICAL SPECIFICATIONS

	19	20	23D	23FB	25	25FB	27FB	28	30	30FB Bunk
Exterior Length	19' 2"	20' 10"	23'	23' 9"	25' 11"	25' 11"	28'	27' 11"	30' 11"	30' 10"
Width Exterior	8'	8'	8'	8'	8' 5.5"	8' 5.5"	8' 5.5"	8' 5.5"	8' 5.5"	8' 5.5"
Width Interior	7' 7"	7' 7"	7' 7"	7' 7"	8' 1"	8' 1"	8' 1"	8' 1"	8' 1"	8' 1"
Height Exterior w/A/C	9' 5"	9' 5"	9' 5"	9' 5"	9' 7"	9' 7"	9' 7"	9' 7"	9' 7"	9' 7"
Height Interior w/A/C	6' 4.5"	6' 4.5"	6' 4.5"	6' 4.5"	6' 5"	6' 5"	6' 5"	6' 5"	6' 5"	6' 5"
Hitch Weight (w/LP and w/o options, water & cargo) (lbs.)	550	631	720	467	835	837	791	976	880	885
Unit Base Weight (w/LP & w/o options, water & cargo) (lbs.)	3,852	4,271	4,761	4,806	5,600	5,503	5,868	5,979	6,382	6,422
Gross Vehicle Weight Rating (lbs.)	4,500	5,000	6,000	6,000	7,300	7,300	7,600	7,600	8,800	8,800
Axles	1	1	2	2	2	2	2	2	2	2
Net Carrying Capacity (NCC=GVWR-UBW) (lbs.)	648	729	1,239	1,194	1,700	1,797	1,732	1,621	2,418	2,378
Fresh Water Tank w/drain valve (gal.)	23	23	39	39	39	39	39	39	54	54
Black Water Tank (gal.)	18	18	18	18	37	39	39	35	38	37
Gray Water Tank (gal.)	21	21	21	30	35	37	37	37	38	39
Water Heater w/electronic ignition (gal.) (XT)	6	6	6	6	6	6	6	6	6	6
A/C w/heat pump (BTU)	13,500	13,500	13,500	13,500	15,000	15,000	15,000	15,000	15,000	15,000
Furnace (BTU)	16,000	18,000	25,000	18,000	25,000	25,000	25,000	30,000	30,000	30,000
LPG (2-30 lb. steel tanks) (lbs.)	60	60	60	60	60	60	60	60	60	60
Deep Cycle Battery (lead acid) Group 24	2	2	2	2	2	2	2	2	2	2
Sleeping Capacity	2-4	2-4	2-5	2-4	2-5	2-5	2-5	2-6	2-6	2-8

Please visit www.airstream.com to see a full set of model specifications, floorplans, features and options, and to find your nearest Airstream dealer.

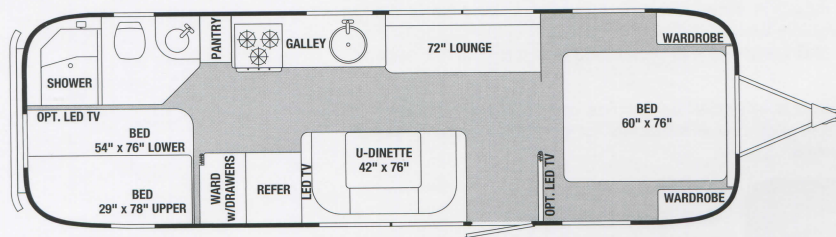
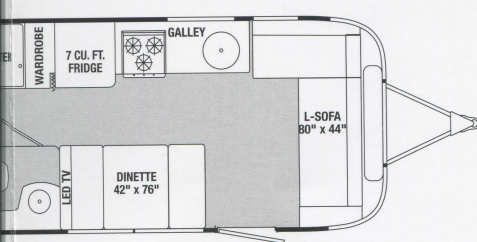

30FB Bunk Flying Cloud

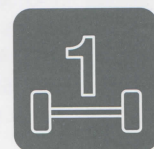
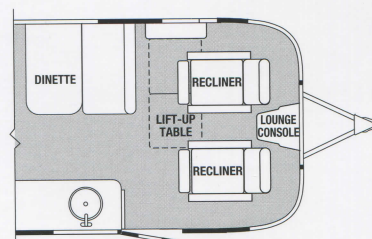
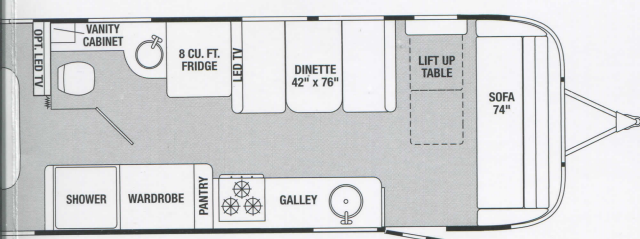

Axle
19 & 20



Axles
23D thru 30FB



GVWR
4,500 - 8,800 lbs



Length
19'2" - 30'10"



Sleeps
2-8



Flying Cloud bunk, twin & queen bed options in Golden Night Décor

Product information, specifications, and photography in this brochure were as accurate as possible at time of printing. Photographs may contain some features that are optional on your vehicle. Since we continually strive to improve our products, actual products may differ. Prices and specifications are subject to change without notice. All capacities are approximate and dimensions are nominal. Some features or options may be different or unavailable in Canada.

Vehicle Loading – Every effort has been made to provide the greatest number of options for the recreation vehicle owner. Along with these choices comes the responsibility to manage the loads that are imposed by the choices so that they remain within the manufacturer's specified chassis weight limits. Do not overload the recreation vehicle.

Dry Weights - based on standard features; optional equipment not included. Net Carrying Capacity (NCC) is determined by subtracting Unit Base Weight (UBW) from the Gross Vehicle Weight Rating (GVWR), and is the capacity available for water, options and cargo. Liquid capacities and weights are approximations only.

Warning – This information is intended as a guide only. Weights of individual vehicles may vary. Consult your owner's manual for complete loading, weighing, and towing instructions.

Airstream now offers
 24/7 roadside
 service & technical
 assistance provided
 by CoachNet.

Coach-Net

RV Membership Plans



nmc
 NATIONAL MOTOR CLUB

Airstream, Inc.
 419 West Pike Street
 P.O. Box 629
 Jackson Center, OH
 45334 USA
 937-596-6111
 www.airstream.com

All content and images
 © Airstream 2013 & 2014

FlyingCloud 15k 8/13



Airstream is a subsidiary of Thor Industries, Inc.