



Celebrating a storied Airstream nameplate, the Land Yacht's contemporary design language incorporates best practice from the world's finest ocean-going craft.

The Land Yacht is the product of an international collaboration between Airstream, Tecnoform S.p.A., maker of fine cabinetry and the design studio of Officina Italiana Design. The resulting interior is truly yacht-like and incorporates elements from the world's finest luxury watercraft.

The 28' Airstream Land Yacht travel trailer is crafted with quality materials and equipment throughout, including boat-deck flooring, LED panel lighting elements, and Corian® solid surfaces.



The Land Yacht's unique floor plan has a number of carefully placed design elements that create a sleek and sophisticated look in the cabin. The rear social space includes a galley that can be hidden when not in use.

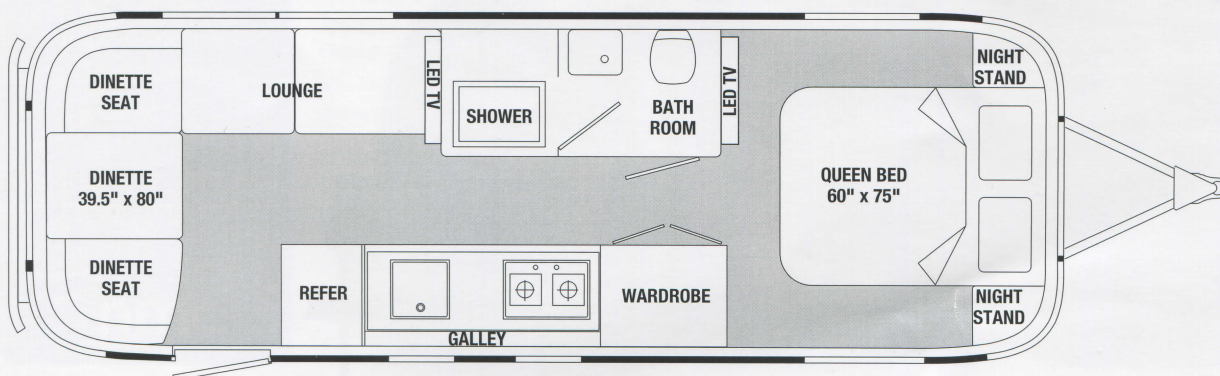



LAND YACHT SPECIFICATIONS

	28FB
Exterior Length	28'
Width Exterior	8' 5.5"
Width Interior	8' 1"
Height Exterior w/A/C	9' 9"
Height Interior w/A/C	6' 7.5"
Hitch Weight (w/LP & w/o options, water & cargo) (lbs.)	900
Unit Base Weight (w/LP & w/o options, water & cargo) (lbs.)	6,586
Gross Vehicle Weight Rating (lbs.)	8,200
Axles	2
Net Carrying Capacity (NCC=GVWR-UBW (lbs.))	1,614
Fresh Water Tank w/drain valve (gal.)	39
Black Water Tank (gal.)	39
Gray Water Tank (gal.)	37
Water Heater w/electronic ignition (gal.) (XT)	6
A/C w/heat pump (BTU)	15,000 (lounge), 15,000 (bedroom)
Furnace (BTU)	25,000
LPG (2-30 lb. steel tanks) (lbs.)	60
Deep Cycle Battery (lead acid) Group 24	2
Sleeping Capacity	2-5

Please visit www.airstream.com to see a full set of model specifications, floorplans, features and options, and to find your nearest Airstream dealer.



The Land Yacht, capable of sleeping up to five people, has a bedroom in the front, a bathroom amidship and a rear social space. The dinette height adjusts at the touch of a button.



Axles



GVWR
8,200 lbs



Length
28'



Sleeping
Capacity



The Land Yacht's powered bed lift reveals access to hidden storage.

Product information, specifications, and photography in this brochure were as accurate as possible at time of printing. Photographs may contain some features that are optional on your vehicle. Since we continually strive to improve our products, actual products may differ. Prices and specifications are subject to change without notice. All capacities are approximate and dimensions are nominal. Some features or options may be different or unavailable in Canada.

Vehicle Loading – Every effort has been made to provide the greatest number of options for the recreation vehicle owner. Along with these choices comes the responsibility to manage the loads that are imposed by the choices so that they remain within the manufacturer's specified chassis weight limits. Do not overload the recreation vehicle.

Dry Weights – based on standard features; optional equipment not included. Net Carrying Capacity (NCC) is determined by subtracting Unit Base Weight (UBW) from the Gross Vehicle Weight Rating (GVWR), and is the capacity available for water, options and cargo. Liquid capacities and weights are approximations only.

Warning – This information is intended as a guide only. Weights of individual vehicles may vary. Consult your owner's manual for complete loading, weighing, and towing instructions.

Airstream now offers
 24/7 roadside
 service & technical
 assistance provided
 by CoachNet.

Coach-Net

RV Membership Plans



nmc
 NATIONAL MOTOR CLUB

Airstream, Inc.
 419 West Pike Street
 P.O. Box 629
 Jackson Center, OH
 45334 USA
 937-596-6111
 www.airstream.com

All content and images
 © Airstream 2013 & 2014

Land Yacht 12k 8/13



Airstream is a subsidiary of Thor Industries, Inc.