



For those intrepid souls who won't settle for anything but the best, Airstream has created a travel trailer like no other. It took an international collaboration between the engineers of Airstream and famed Riva boat designer Mauro Micheli from the studio of Officina Italiana Design to create this retreat that incorporates elements from the finest Italian luxury watercraft.

Inside, the Land Yacht flourishes with elegant curved cabinetry and sumptuous padded surfaces with detail-stitching, complementing the sleek, streamlined nautical styling that cleverly hides a host of practical features and premium upgrades.

The most luxurious Airstream ever conceived.

28FB LAND YACHT





The Land Yacht's unique floorplan has a number of carefully placed design elements that create a sleek and sophisticated look in the cabin. The rear social space includes a galley that can be hidden when not in use.

Interior Décors

- Polar
- Mocha

Land Yacht Floorplan

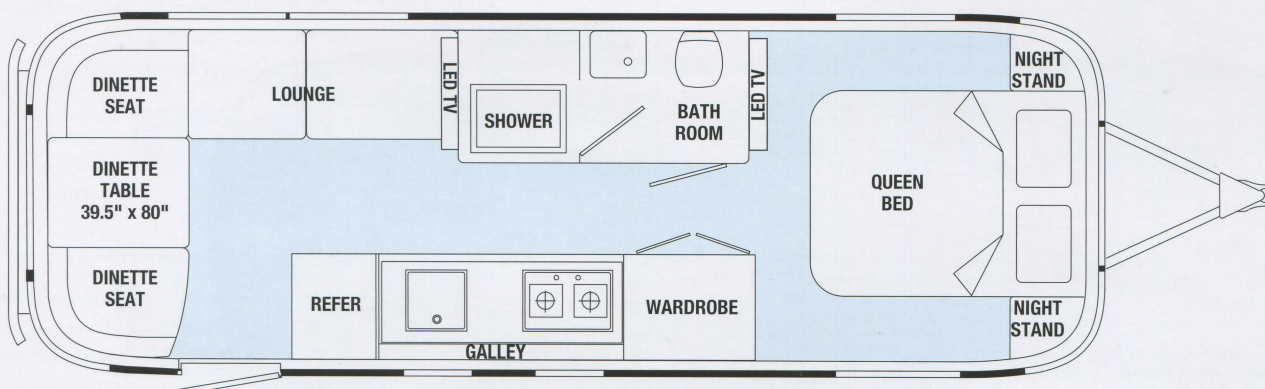

28FB Land Yacht

SPECIFICATIONS

28FB

Exterior Length	28'
Width Exterior	8' 5.5"
Width Interior	8' 1"
Height Exterior w/A/C	9' 9"
Height Interior w/A/C	6' 6"
Hitch Weight (w/LP & w/o options, water & cargo) (lbs.)	842
Unit Base Weight (w/LP & w/o options, water & cargo) (lbs.)	6,586
Gross Vehicle Weight Rating (lbs.)	8,200
Net Carrying Capacity (NCC=GVWR-UBW (lbs.)	1,614
Fresh Water Tank w/drain valve (gal.)	39
Gray Water Tank (gal.)	37
Black Water Tank (gal.)	39
Water Heater w/electronic ignition (gal.) (XT)	6
A/C w/heat pump (BTU)	30,000
Furnace (BTU)	25,000
LP (2 - 30 lb. steel tanks) (lbs.)	60
Deep Cycle Battery (lead acid) Group 24	2
Sleeping Capacity	2-5

Please visit www.airstream.com to learn more and to find your nearest Airstream Dealer.



The Land Yacht, capable of sleeping up to five people, has a bedroom in the front, a bathroom amidship and a rear social space. The dinette height adjusts at the touch of a button.



Axles



GVWR
8,200 lbs



Length
28'



Sleeps



Airstream Online

Learn more! visit www.airstream.com

To find more helpful hints, product selector tools,
 locate a dealer or learn more about our heritage
 and our community,
 please visit www.airstream.com.



THOR
 INDUSTRIES, INC.



Proudly made
 in the U.S.A.

Airstream is a subsidiary
 of Thor Industries, Inc.

Airstream now offers
 24/7 roadside service &
 technical assistance
 provided by CoachNet.

Coach-Net
 RV Membership Plans



Airstream, Inc.
 419 West Pike Street
 P.O. Box 629
 Jackson Center, OH 45334
 USA

937-596-6111

All content and images
 © Airstream 2014 & 2015
 Land Yacht 10k 10/14

Product information, specifications, and photography in this brochure were as accurate as possible at time of printing. Photographs may contain some features that are optional on your vehicle. Since we continually strive to improve our products, actual products may differ. Prices and specifications are subject to change without notice. All capacities are approximate and dimensions are nominal. Some features or options may be different or unavailable in Canada.

Vehicle Loading – Every effort has been made to provide the greatest number of options for the recreation vehicle owner. Along with these choices comes the responsibility to manage the loads that are imposed by the choices so that they remain within the manufacturer's specified chassis weight limits. Do not overload the recreation vehicle.

Dry Weights - based on standard features; optional equipment not included. Net Carrying Capacity (NCC) is determined by subtracting Unit Base Weight (UBW) from the Gross Vehicle Weight Rating (GVWR), and is the capacity available for water, options and cargo. Liquid capacities and weights are approximations only.

Warning – This information is intended as a guide only. Weights of individual vehicles may vary. Consult your owner's manual for complete loading, weighing, and towing instructions.