

adventure, inspired by
AIRSTREAM



Efficiency is in the Sport's DNA, inside and out. This travel trailer is lightweight for fuel economy in towing, and superbly designed with features that more than earn the label "premium compact". In both 16 and 22FB floorplans, the Sport packs a big travel punch – with a maximum of plush comforts and a minimum of wasted space.

Easy to tow and easy to love, the Sport is designed for travelers who want to hitch-up and go!



16 SPORT



SPECIFICATIONS

	16	22FB
Exterior Length	16' 4"	21' 8"
Exterior Width	8'	7' 3.25"
Interior Width	7' 7"	6' 11.75"
Exterior Height with A/C	9' 3"	9' 3"
Interior Height with A/C	6' 4.5"	6' 3"
Hitch Weight (w/LP & w/o options, water & cargo) (lbs.)	350	393
Unit Base Weight (w/LP & w/o options, water & cargo) (lbs.)	2,860	3,634
Gross Vehicle Weight Rating (lbs.)	3,500	4,500
Net Carrying Capacity (NCC=GVWR-UBW) (lbs.)	640	866
Fresh Water Tank (gal.)	23	20
Gray Water Tank (gal.)	N/A	24
Black Water Tank (gal.)	N/A	18
Combination Black & Gray Tank (gal.)	21	N/A
Water Heater w/electronic ignition (gal.)	6	6
A/C (BTU)	11,000	13,500
Furnace (BTU)	12,000	12,000
LP (2 - 20 lb. steel tanks)	40	40
Deep Cycle Battery (lead acid) Group 24	1	1
Sleeping Capacity	2-3	2-4

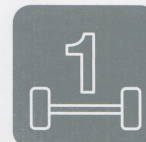

Axle



GVWR
3,500 - 4,500 lbs.



Length
16'4" - 21'8"



Sleeps

Please visit www.airstream.com to learn more and to find your nearest Airstream Dealer.

Sport Floorplans

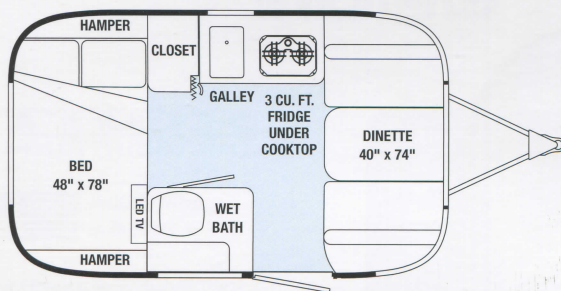

16 Sport

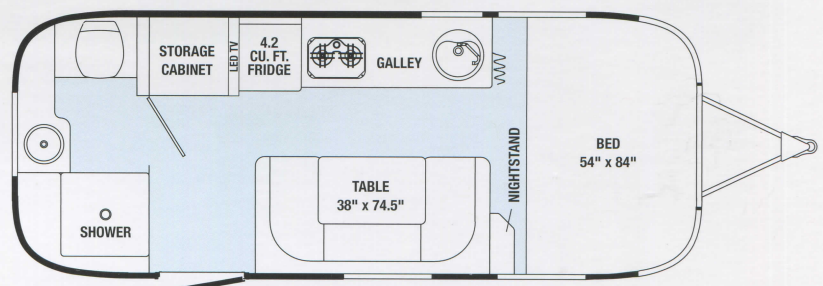

22FB Sport





Interior Décors

- Mocha Blue
- Sharkskin
- Golden Ultraleather™ Option
- Black Ultraleather™ Option

22FB SPORT





Airstream Online

Learn more! visit www.airstream.com

To find more helpful hints, product selector tools,
 locate a dealer or learn more about our heritage
 and our community,
 please visit www.airstream.com.



THOR
 INDUSTRIES, INC.



Proudly made
 in the U.S.A.

Airstream is a subsidiary
 of Thor Industries, Inc.

Airstream now offers
 24/7 roadside service &
 technical assistance
 provided by CoachNet.



Airstream, Inc.
 419 West Pike Street
 P.O. Box 629
 Jackson Center, OH 45334 USA
 937-596-6111

All content and images
 © Airstream 2014 & 2015
 Sport 15k 10/14

Product information, specifications, and photography in this brochure were as accurate as possible at time of printing. Photographs may contain some features that are optional on your vehicle. Since we continually strive to improve our products, actual products may differ. Prices and specifications are subject to change without notice. All capacities are approximate and dimensions are nominal. Some features or options may be different or unavailable in Canada.

Vehicle Loading – Every effort has been made to provide the greatest number of options for the recreation vehicle owner. Along with these choices comes the responsibility to manage the loads that are imposed by the choices so that they remain within the manufacturer's specified chassis weight limits. Do not overload the recreation vehicle.

Dry Weights - based on standard features; optional equipment not included. Net Carrying Capacity (NCC) is determined by subtracting Unit Base Weight (UBW) from the Gross Vehicle Weight Rating (GVWR), and is the capacity available for water, options and cargo. Liquid capacities and weights are approximations only.

Warning – This information is intended as a guide only. Weights of individual vehicles may vary. Consult your owner's manual for complete loading, weighing, and towing instructions.