



AIRSTREAM®

2026 Dual-Axle Travel Trailers Floor Plan Comparison

More space, more features, and more travel possibilities. Airstream's dual-axle travel trailer lineup offers larger floorplans that incorporate more comforts of home, more living space for family and friends, and more options to make it your own. Built with more than 90 years of expert design and hand-made craftsmanship, our dual-axle model lines are ready to make big travel dreams come true.

Learn more at airstream.com/blog/dual-axle

23-Foot Models: Key Points

- Three 23-foot floor plans are nearly identical, except for respective model line decor choices. The FB (front bed) layout puts a queen or twin beds up front, a convertible dinette over the axles, and a wide three-piece bathroom in the rear.
- Our smallest dual-axle trailers, the 23FB floor plans prize compact efficiency with all the comforts of home. Front panoramic windows and wide windows over the dinette fill the interior with light, while the all-in-one bathroom setup is a favorite among owners.



Trade Wind® 23FB

Unit Base Weight: 5650 lbs.
Exterior Length: 23' 11"
GVWR: 6,500 lbs.



Flying Cloud® 23FB

Unit Base Weight: 5,000 lbs.
Exterior Length: 23' 11"
GVWR: 6,000 lbs.



International 23FB

Unit Base Weight: 5,100 lbs.
Exterior Length: 23' 11"
GVWR: 6,000 lbs.

25-Foot Models: Key Points

- A diverse collection of travel trailers, the 25-foot lineup offers something for every travel style. Note queen bed position in the RB (rear bed) and FB models, and the way twin beds in the FB models open up the space from rear to front. All 25-foot models feature mid-ship bathroom/shower combos split across the aisle.
- Note panoramic windows at front and rear, letting in ample light and expanding the feel inside. Decor choices, fixtures, and materials are the major differentiators in the versatile 25-foot lineup, which includes the optional rear hatch feature in the Trade Wind, Flying Cloud and International line.



Trade Wind® 25FB
Unit Base Weight: 6,300 lbs.
Exterior Length: 26' 2"
GVWR: 7,600 lbs.



Flying Cloud® 25FB
Unit Base Weight: 5,650 lbs.
Exterior Length: 26' 2"
GVWR: 7,300 lbs.



International 25FB
Unit Base Weight: 5,700 lbs.
Exterior Length: 26' 2"
GVWR: 7,300 lbs.

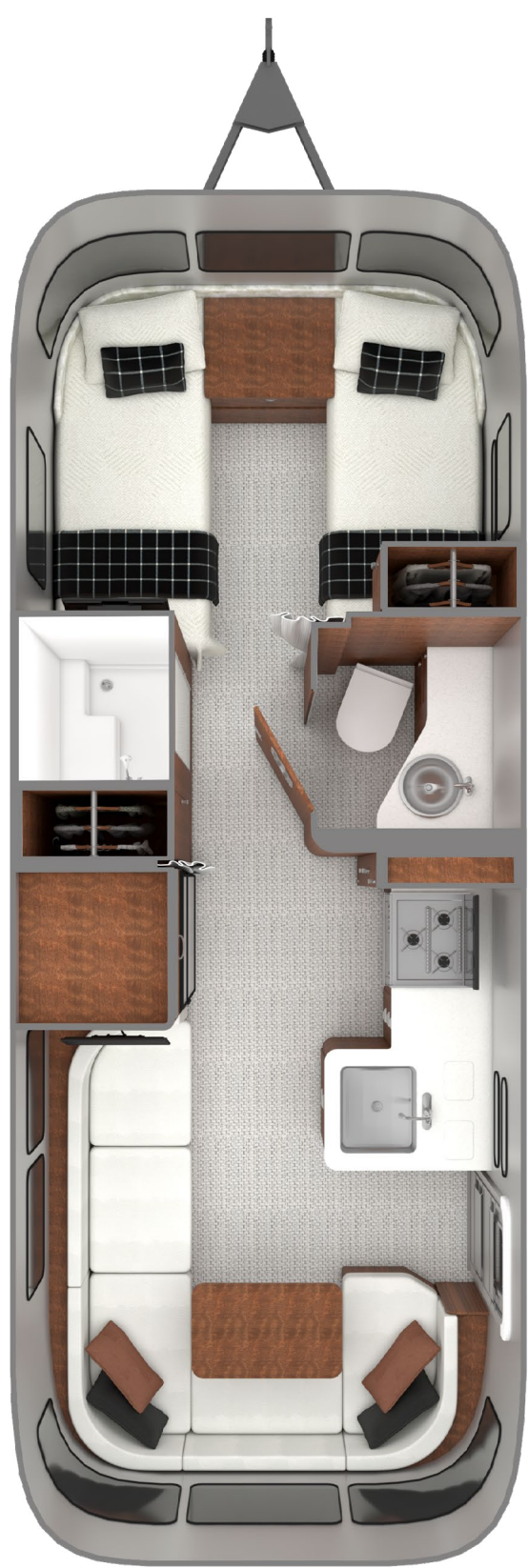

Globetrotter® 25FB
Unit Base Weight: 5,975 lbs.
Exterior Length: 26' 2"
GVWR: 7,300 lbs.

27-Foot Models: Key Points

- Our most popular traditional travel trailer floor plan, the 27FB offers the perfect blend of space, style, and features. All three are identical except for decor, fixtures, and materials, with a family-friendly front bunk option in Flying Cloud, and elevated design-centric decors in International and Globetrotter.
- The optional rear hatch for Flying Cloud and International (25FB and 27FB models) is a popular, versatile feature that lets you open up the dinette area for al fresco dining (or load bikes, kayaks, and other gear). Note how the twin bed setup opens a straight line from rear to front, while creating a separate area for relaxing and socializing.



Flying Cloud® 27FB

Unit Base Weight: 5,950 lbs.
Exterior Length: 28' 2"
GVWR: 7,600 lbs.



International 27FB

Unit Base Weight: 6,000 lbs.
Exterior Length: 28' 2"
GVWR: 7,600 lbs.



Globetrotter® 27FB

Unit Base Weight: 6,300 lbs.
Exterior Length: 28' 2"
GVWR: 7,600 lbs.

28-Foot Models: Key Points

- Though almost identical in exterior length, the 28RB models offer a significantly different feel over their 27-foot siblings. Main entry doors at the front of the trailer open into spacious living areas with L-shaped lounges that double as sleeping space when the day is done. At the rear are queen or twin beds nestled under panoramic windows that offer exceptional morning views.
- Convertible dinettes across from the galley double as extra sleeping space, while the bathroom/shower combo is split across the aisle, with the exception of the Frank Lloyd Wright Limited Edition. The floor plan offers panoramic windows at the front and rear, as well as wide windows mid-ship that expand the space by filling it with natural daylight.
- The Frank Lloyd Wright Usonian Limited Edition is unlike any trailer in Airstream’s fleet. Enjoy the splendor of nature from the Rear Hatch located in the dual-purpose primary bedroom, featuring twin beds that convert to a king at the push of a button. A limited run of only 200 trailers will be built, with incredible interior design inspired by Wright’s multi-use, small space designs.



Classic 28RB

Unit Base Weight: 7,650 lbs.
Exterior Length: 28' 10"
GVWR: 8,800 lbs.



Flying Cloud® 28RB

Unit Base Weight: 5,900 lbs.
Exterior Length: 28' 2"
GVWR: 7,600 lbs.



International 28RB

Unit Base Weight: 5,900 lbs.
Exterior Length: 28' 2"
GVWR: 7,600 lbs.



Frank Lloyd Wright
Usonian Limited Edition 28RB

Unit Base Weight: 6,800 lbs.
Exterior Length: 28' 2"
GVWR: 7,600 lbs.

All floorplans are available in queen or twin bedroom configurations, with the exception of the FLW LE

30-Foot Models: Key Points

- Airstream’s 30-foot lineup showcases four of our most stunning and versatile models, each offering unique features you won’t find anywhere else. Highlights include the Flying Cloud Bunk model, which sleeps up to eight, and the Globetrotter lounge, designed to seat up to ten comfortably, accompanied by a farmhouse-style table, perfect for entertaining.
- 30-foot International, Globetrotter, and Classic models feature rear beds with elevated decors and expanded features. From power stabilizing jacks and retractable awnings to solid surface countertops, the International, Globetrotter, and Classic models offer a suite of luxurious features that elevate comfort, convenience, and luxury on the road.



Flying Cloud® 30FB Bunk

Unit Base Weight: 6,700 lbs.
Exterior Length: 31' 2"
GVWR: 8,800 lbs.



International 30RB

Unit Base Weight: 6,600 lbs.
Exterior Length: 31' 2"
GVWR: 8,800 lbs.



Globetrotter® 30RB

Unit Base Weight: 6,925 lbs.
Exterior Length: 31' 2"
GVWR: 8,800 lbs.



Classic 30RB

Unit Base Weight: 7,725 lbs.
Exterior Length: 31' 5"
GVWR: 10,000 lbs.

All floorplans are available in queen or twin bedroom configurations

33-Foot Model: Key Points

- As Airstream’s flagship, the Classic 33FB stands apart with every available feature included, such as MyAirstream™ connected technology, stainless steel exterior components, a standard solar package, and powered awning and stabilizer jacks. While other models offer select premium touches, the Classic delivers a fully loaded experience designed for those who want nothing less than the pinnacle of luxury and convenience
- Inside, you’ll discover elevated design touches like hand-crafted Shaker-style cabinetry, a 32” Smart TV with a power lift positioned across from dual reclining sofa for a true movie theater experience, and a show-stopping residential bathroom that spans the entire rear of the trailer.



Classic 33FB

Unit Base Weight: 8,425 lbs.
Exterior Length: 33’ 3”
GVWR: 10,000 lbs.

RESOURCES

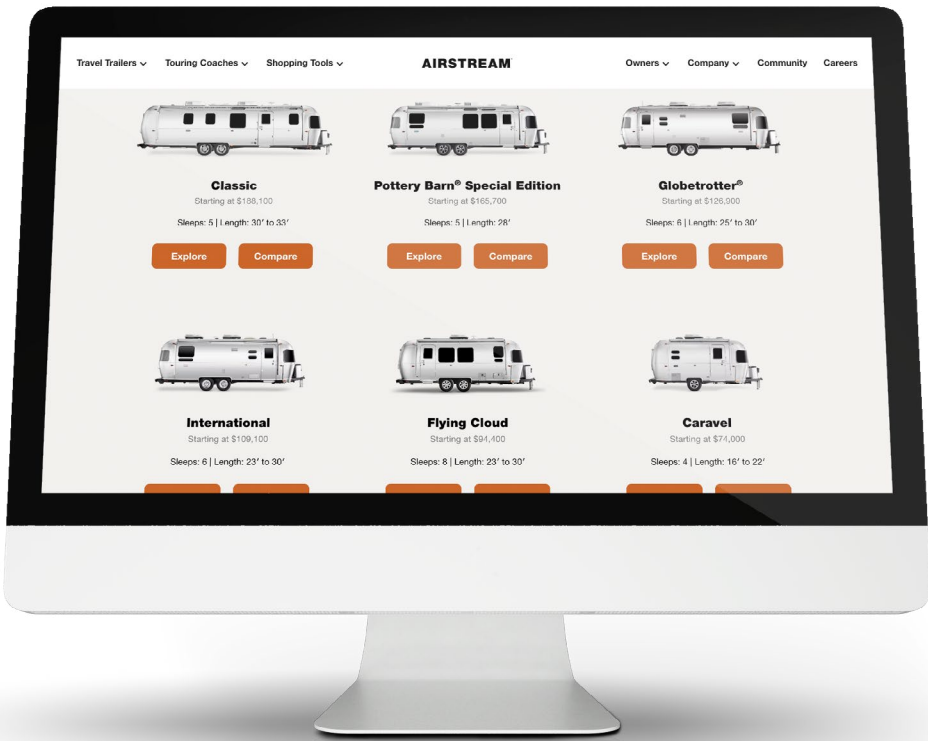

See All Airstream Travel Trailers

While you’re shopping, you’re bound to have specific questions about certain models, features, and more.

Whether you’re still researching or ready to buy tomorrow, your Airstream dealer is here to help you get the answers you need. [Find your dealer](#) and take a zero-pressure walkthrough in person.

Explore Travel Trailers

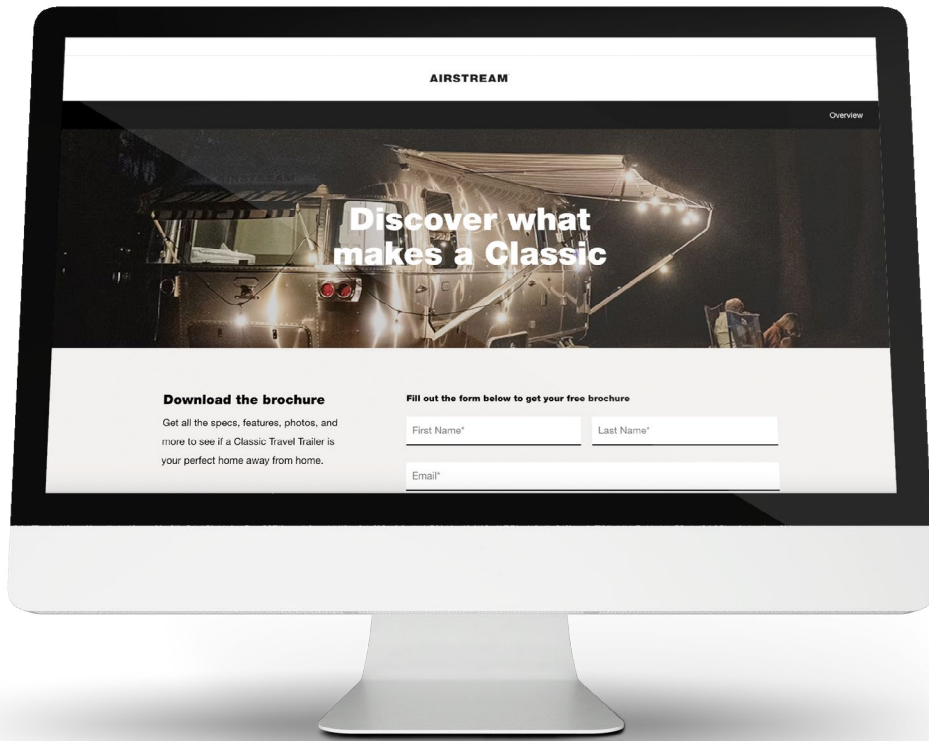

Download our Brochures

Start with any model and choose a floor plan, interior décor, and additional options that feel right for you.

When you’re done configuring, you’ll receive a tailor-made brochure to download, print, or share.

Classic

Frank Lloyd Wright

Globetrotter®

Trade Wind®

International

Flying Cloud®

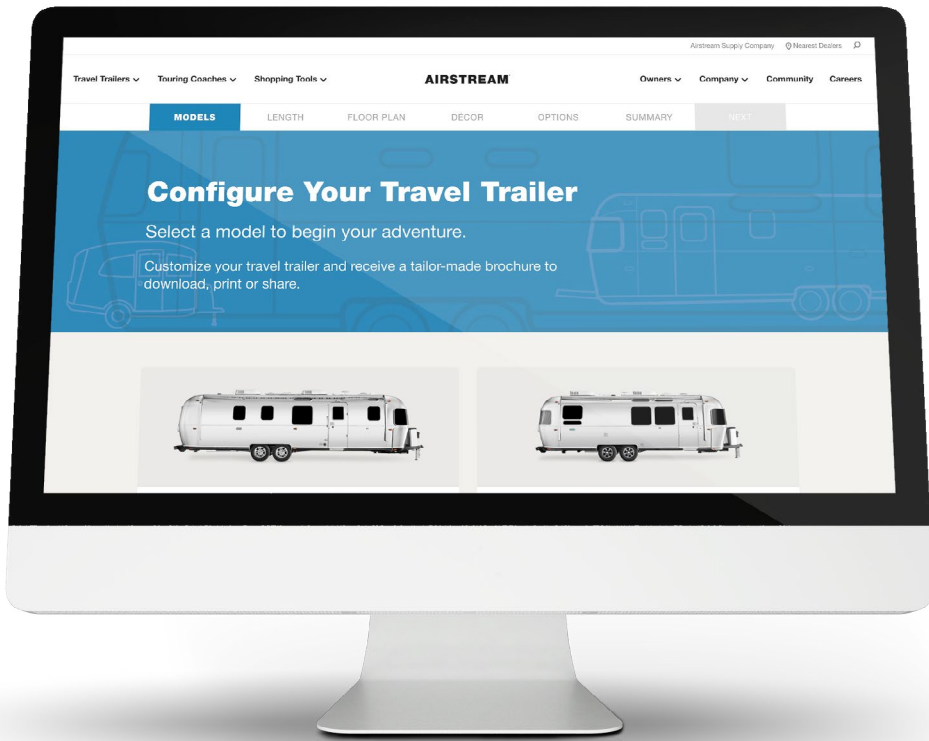

Configure Your Perfect Airstream

Start with any model and choose a floor plan, interior décor, and additional options that feel right for you.

When you’re done configuring, you’ll receive a tailor-made brochure to download, print, or share.

Configure Yours

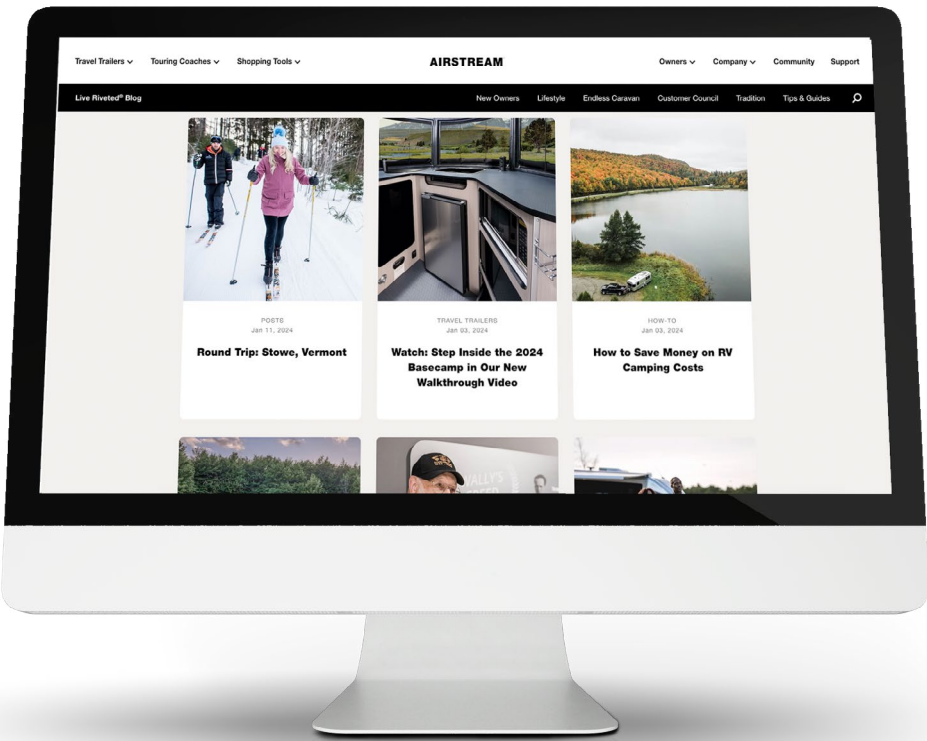

Explore Our Blogs

Connect to our community by diving in to our blog, where you’ll find compelling stories and valuable perspectives.

Read More



Learn more at airstream.com/blog/dual-axle