

A MEMBER OF AIRSTREAM'S CRUISING FLEET

26-foot

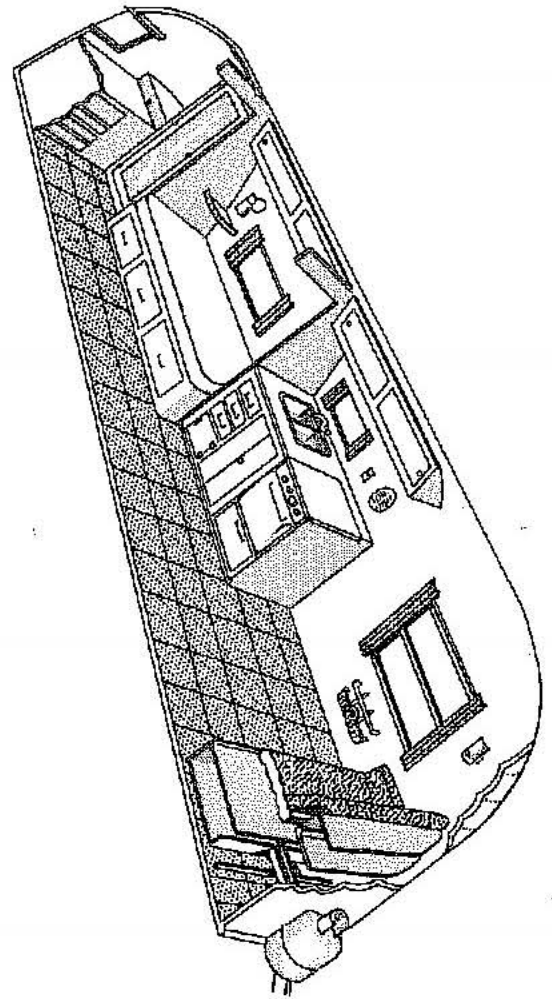
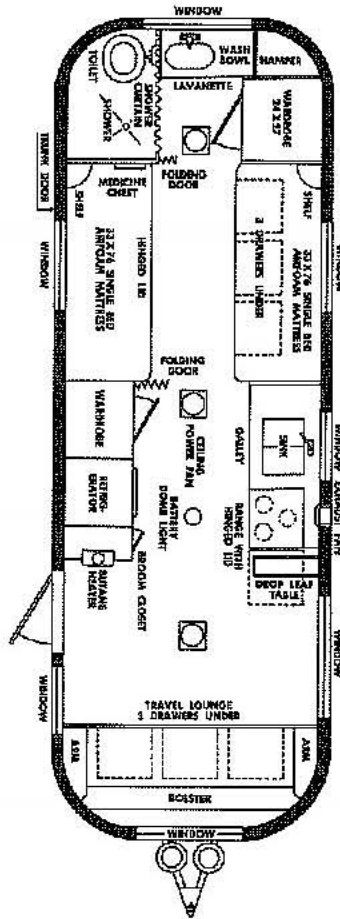
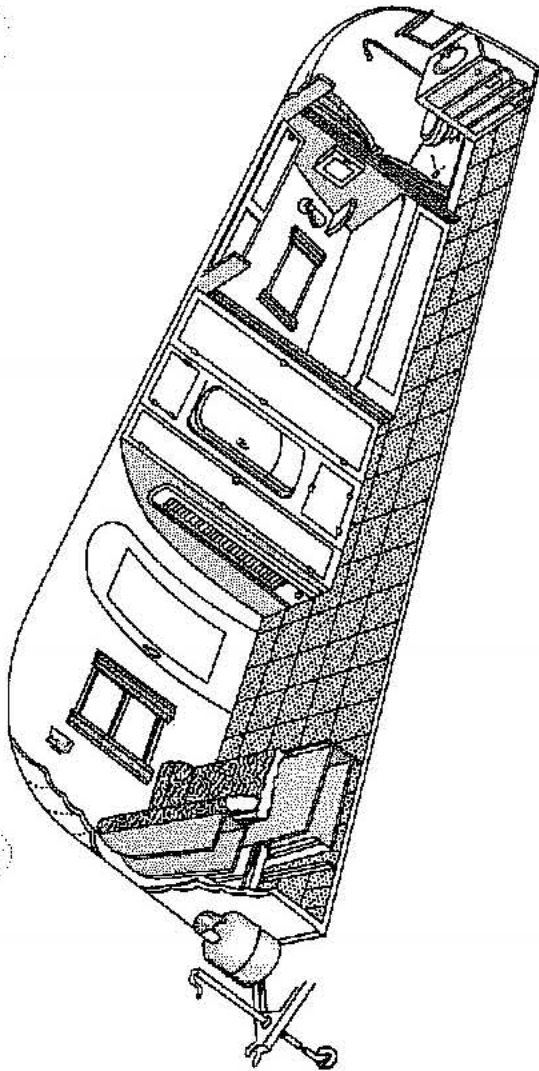

✓ CHECK THESE FEATURES!

- of the New . . . OVERLANDER

Overall length — 26 ft.
 Body length — 23 ft.
 Overall weight — 3,170 lbs.
 Hitch weight — 260 lbs.
 Choice of 3 interior wall colors.
 33' x 76" rectangular twin beds.
 Featherlite lifetime airfoam mattresses.
 Rear bathroom, Marine type flushing toilet, shower and 3 drawer lavanette.
 Airfoam sofa in front, convertible to double bed.
 Combination 5.6 cu. ft. ice-electric refrigerator with freezer.
 Hot water heater. Butane radiant heater.
 5' leatherweight drop-leaf table.
 Standard apartment range, 3 burner, oven and broiler.

Exhaust fan in wall over stove.
 Double sinks, swing faucet.
 Closet for home appliances.
 Airstream's "Airliner" curtains.
 Beautifully grained wood cabinets.
 Linoleum tiled floor. Formica galley top.
 48" wardrobe space, 9 drawers, 212" of roof lockers.
 9 crank operated windows.
 3 roof vents. Power fan in center vent.
 12 volt battery dome light.
 16 ft. awning rail. Porch light.
 Double butane tanks.
 Weatherproof 110-Volt electrical outlet.
 Trunk compartment large enough for spare tire.
 Touch control, built-in step.

Warp-free hollow core cabinet doors.
 Imported "Sta-closed" closet catches.
 Radio Antenna. Electric brakes.
 Fiberglass insulation.
 Escape type rear window.
 Steel bumpers, shock absorbers.
 Truck wheels, 700 x 15, 8 ply tires.
Only permissible extra features at additional cost.
 Pressurized water system.
 Septic tank for toilet.
 Gas water heater.
 3.9 cu. ft. gas refrigerator.
 Puncture proof tubes.
 Airfoam bunks over twin beds.

Specifications and prices subject to change without notice.

EFFORTLESS, CAREFREE TRAILERING? TRY AIRSTREAM

Litho in U.S.A.

WORLD FAMOUS • ALL ALUMINUM • TRAVEL TRAILERS

AIRSTREAM

1957
MODEL

26-foot

★ ★ ★ *Superlative* **OVERLANDER** ★ ★ ★

*Beauty in every line,
comfort in every nook and cranny,
efficient in every operation.
A sound, practical investment.*



● This family size, self sufficient "Airstream" is liveable anywhere; crowded highways or remote byways. Spacious and convenient, its surprisingly light weight, just over 3000 lbs., provides effortless handling and mobility. A wonderful trailer for vacationing and caravanning, but also a trailer, so comfortable, that it is ideally suited for long business tours with extended stops.

● The "Overlander" sleeps four but can sleep six by addition of permissible extras at moderate extra cost. The location of the rectangular twin beds gives the interior a feeling of extra spaciousness. Close by is a modern bathroom with shower, toilet, clothes hamper and a luxurious built in formica top lavanette complete with wash bowl and three drawers. A rear wardrobe is handy to bath. Two folding doors offer strict privacy for both bathroom and bedroom. The tailored, streamlined galley features, in addition to the eye level off floor combination ice-electric refrigerator, a unique hinged fold-over stove cover that adds useful formica work table space adjacent to the range and provides the same handy work space adjacent to sink when range is covered.

● Even greater off the road independence is yours by addition of Wally Byam Caravan tested optional extras, listed on reverse side.

**WORLD'S
FINEST
LIGHTWEIGHT
TRAVEL
TRAILERS**



AIRSTREAM
TRAILERS, INC.

JACKSON CENTER - SHELBY COUNTY, OHIO